

Hard Ings Road Improvements, Keighley

Ecological Appraisal

May 2016

QUANTS environmental Ltd

Tel: 01765 600799

Email: info@quantsenvironmental.com

Web: www.quantsenvironmental.com

Contents

1	Introduction	4
2	Methodology.....	5
2.1	Desk Study	5
2.1.1	Ecological Records Request.....	5
2.1.2	Additional Data Sources.....	5
2.2	Field Survey	5
2.3	Limitations	5
3	Results	6
3.1.1	Desk Study	6
3.1.2	Internationally and Nationally Designated Sites.....	6
3.1.3	Locally Designated Sites.....	6
3.1.4	Protected / Notable Species Records	6
3.2	Habitats	7
3.2.1	Overview	7
3.2.2	Hard Standing, Buildings and Walls.....	7
3.2.3	Amenity Grassland	7
3.2.4	Mixed Plantation Woodland	7
3.2.5	Broad-leaved Plantation Woodland	7
3.2.6	Tall Ruderal	8
3.2.7	Broad-leaved Trees.....	8
3.3	Protected / Notable Species.....	8
3.3.1	Amphibians.....	8
3.3.2	Reptiles	8
3.3.3	Birds	8
3.3.4	Bats	9
3.3.5	Other Fauna	9
4	Conclusions and Recommendations.....	10
4.1	Conclusions.....	10
4.1.1	Designated Sites	10

4.1.2 Habitats	10
4.1.3 Amphibians.....	10
4.1.4 Birds	10
4.1.5 Bats	10
4.1.6 Other Fauna	10
4.2 Recommendations	10
4.2.1 Habitats	10
4.2.2 Carbon Sequestration	11
4.2.3 Birds	11
4.2.4 Bats	11
4.2.5 Other Fauna	11
Appendix 1. Legislation Context.....	12
Appendix 2. Phase 1 Habitat Map and Target Notes	13
Appendix 3. Nesting Bird Constraints Plan.....	14
Appendix 4. Photographs.....	15
Appendix 5. Information Provided by WYES.....	18

1 Introduction

This report presents the results of an ecological appraisal undertaken in relation to proposed improvements to Hard Ings Road, Keighley. The road improvement scheme extends between approximate grid references SE06224236 at the north-western end of the scheme and SE06814196 at the south-eastern end. The scheme is located on the northern side of the settlement of Keighley.

Hard Ings Road (A650) is a major carriageway which runs west to east through the upper reaches of Keighley and forms part of the Airedale Corridor which links the principal towns of Skipton and Keighley to Leeds and Bradford. The River Aire lies approximately 400 metres north of Hard Ings Road; Victoria Park lies immediately south of Hard Ings Road near the Bradford Road Roundabout at the eastern end of the scheme; and Keighley Cricket Club lies immediately north of Hard Ings Road in the central/western part of the scheme. Aside from Victoria Park and Keighley Cricket Club, the land uses adjacent to the scheme area are dominated by industrial units, retail units, terraced housing, roads and car parking areas.

The scheme involves improvements to Beechcliffe Roundabout (SE062421); a section of the A629 extending approximately 190 metres north from the centre of Beechcliffe Roundabout; and a section of the A650 extending approximately 650 metres east from the centre of Beechcliffe Roundabout towards Bradford Road Roundabout.

The road scheme involves improvements such as an additional lane on the southbound approach (A629) to Beechcliffe Roundabout; signalising; installation of shared two way cycle and pedestrian footways; installation of a toucan crossing; construction of retaining walls; and widening of the carriageway at Beechcliffe Roundabout.

The aim of this report is to provide a baseline of all ecological considerations relating to the scheme. This includes the identification of any potential ecological constraints; recommendations for mitigation, compensation and enhancement; and recommendations for further work where necessary.

Figure 1. Scheme Extent (aerial imagery dated 2009)

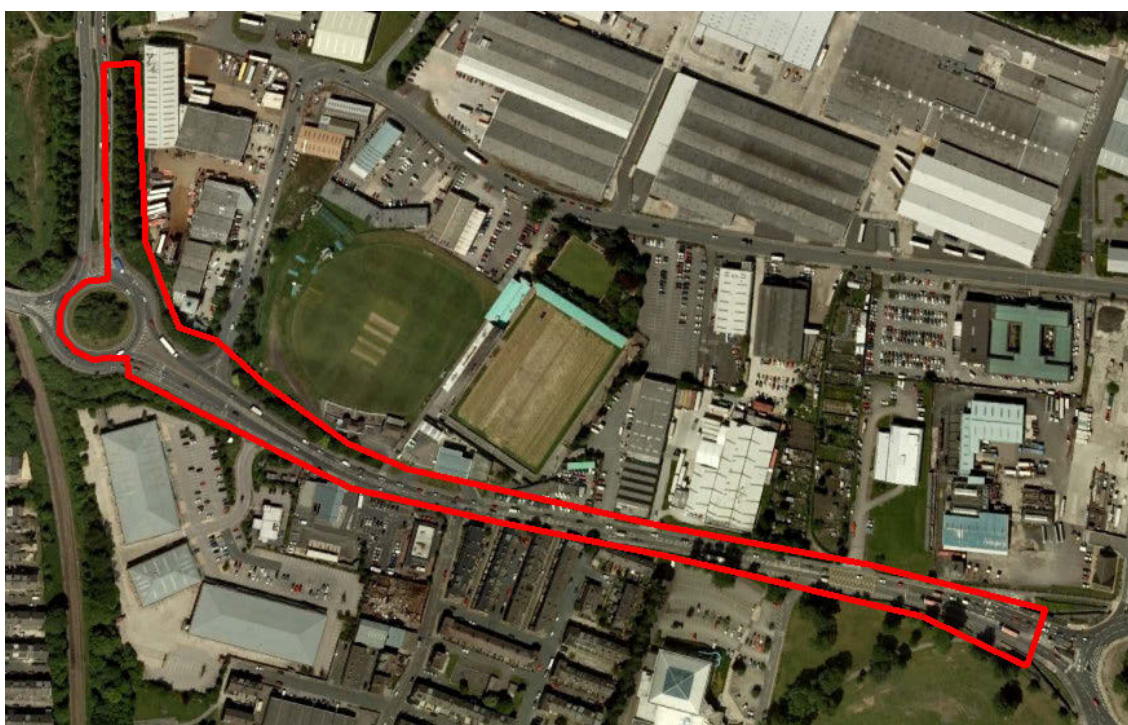

2 Methodology

2.1 Desk Study

2.1.1 Ecological Records Request

A data search was commissioned from West Yorkshire Ecology Service (WYES) in order to provide the appraisal with ecological information which has been collected within a 2 km radius of the site centre. WYES provided information which primarily relates to the following criteria:

- Species legally protected under the Conservation of Habitats and Species Regulations 2010 and the Wildlife and Countryside Act 1981 (as amended).
- Notable species including Local Biodiversity Action Plan priority species and ‘Species of Principal Importance for the Conservation of Biodiversity in England’ as listed in Section 41 of the Natural Environment and Rural Communities Act 2006 (referred to as ‘S41 listed’ species throughout this report).
- Statutorily protected nature conservation sites.
- Locally designated nature conservation sites.

2.1.2 Additional Data Sources

The below listed data sources were searched to gather additional ecological data of relevance to the appraisal including the identification of habitats recognised as being of ‘principal importance’ (NERC Act ‘S41 Listed’ Habitats) and the identification of non-designated ecologically sensitive habitats such as vegetation corridors, woodlands, watercourses and standing water within the scheme area and the wider area up to 500 metres from the scheme area.

- Multi-Agency Geographic Information for the Countryside (MAGIC).
- Ordnance Survey 1:10,000 mapping.
- Aerial imagery (dated 2009 and 2012).

2.2 Field Survey

An extended Phase 1 Habitat Survey of the scheme area was undertaken on 22nd April 2016 by Toby Fisher CEnv MCIEEM in accordance with the standard methodology for Phase 1 Habitat Survey¹. The survey was ‘extended’ to include an assessment of the potential for the scheme area to support protected/notable species. The scheme area was searched for evidence of protected/notable species and was assessed in terms of its potential to support such species. The survey covered the scheme area plus the immediately adjacent areas. The weather conditions at the time of survey were: 5°C; 80% cloud cover; wind Beaufort Scale 2; and good visibility.

2.3 Limitations

The field survey was undertaken outside of the optimum season for phase 1 habitat survey (May to September). Nonetheless, during the survey it was possible to identify a significant proportion of plant species to provide an accurate representation of the habitats present. There were no significant survey limitations.

¹ JNCC, (2010), Handbook for Phase 1 habitat survey - a technique for environmental audit, ISBN 0 86139 636 7.

3 Results

3.1.1 Desk Study

The ecological records search report as supplied by WYES is included at Appendix 5. The report provides a list of species information along with the distances from the site in which the species records were made. A brief summary of the ecological information of most relevant to the scheme plans is provided below.

3.1.2 Internationally and Nationally Designated Sites

There are no internationally or nationally designated sites within a 2 km radius of the scheme centre.

3.1.3 Locally Designated Sites

Table 1 provides the details of locally designated sites located within a 2 km radius of the scheme centre. The details and location of each site are provided in the WYES report at Appendix 5. The nearest designated site is Beechcliffe Ox-Bow Lake BWA located approximately 280 metres north of the scheme area at its nearest point.

Table 1: Protected Nature Conservation Sites within 2 km of the Scheme

Designation	Site Name	Proximity to Scheme
Internationally or nationally designated sites	-	-
Sites of Ecological or Geological Importance (SEGI)	Leeds-Liverpool Canal (part Leeds) Beechcliffe Ings	720m north 300m north-north-west
Local Wildlife Sites (LWS)	Elam Wood How Beck Wood Low Wood Park Wood Stockbridge Nature Reserve	730m north-east 1630m east-north-east 1300m north-west 890m south 430m north-east
Bradford Wildlife Areas (BWA)	STOCKBRIDGE NATURE RESERVE BEECHCLIFFE OX-BOW LAKE ELAM WOOD, Keighley LOW WOOD, Keighley PARK WOOD, Keighley RIDDLESDEN HOSPITAL (Disused) NORTH BECK, Keighley	430m north-east 280m north 730m north-east 1300m north-west 890m south 1480m east-north-east 1430m south-west

3.1.4 Protected / Notable Species Records

Birds: WYES supplied numerous records of birds including several records within 2 km of the site including species listed on Section 41 of the NERC Act 2006 as Species of Principal Importance for the conservation of biodiversity in England. Records include Kingfisher, Skylark, Tree Pipit, Meadow Pipit, Swift, Linnets, Cuckoo, Lesser Spotted Woodpecker, Yellowhammer, Reed Bunting, Peregrine, Pied Flycatcher, Grasshopper Warbler, Spotted Flycatcher, Curlew, Marsh Tit, House Sparrow, Tree Sparrow, Grey Partridge, Wood Warbler, Dunnock, Bullfinch, Starling, Song Thrush and Lapwing.

Reptiles: WYES supplied a single record of Grass Snake only (c1890).

Amphibians: Records of Common Frog and Common Toad (>600m from site).

Bats: Records are varied and include *Myotis* species, whiskered, Leisler's, noctule, Daubenton's, common and soprano pipistrelle and several records of unidentified bats. There are no roost records within or immediately adjacent to the scheme.

Badger: WYES provided several records of badger (none within 500 metres of the scheme area). The information has been withheld due to the threat from illegal persecution.

Other Mammals: Brown hare and Hedgehog.

3.2 Habitats

Please also refer to photographs in Appendix 4 and the Breeding Bird Constraints Plan in Appendix 3.

3.2.1 Overview

The scheme area is focussed on the existing Hard Ings Road (A650) and the A629; both of which are busy roads. The River Aire lies approximately 400 metres north of Hard Ings Road; Victoria Park lies immediately south of Hard Ings Road near the Bradford Road Roundabout at the eastern end of the scheme; and Keighley Cricket Club lies immediately north of Hard Ings Road in the central/western part of the scheme. Aside from Victoria Park and Keighley Cricket Club, the land uses adjacent to the scheme area are dominated by industrial units, retail units, terraced housing, roads and car parking areas. To the north-west of Beechcliffe Roundabout lies an area of broad-leaved scrub and woodland which provides habitat connectivity to the semi-natural habitats of the Aire Valley to the north.

3.2.2 Hard Standing, Buildings and Walls

Hard standing, buildings and walls are the most abundant habitat types within the scheme area (see Photos 3 and 4, Appendix 4). These areas are generally devoid of vegetation except for sparsely distributed individual plants able to grow through cracks such as Danish scurvy-grass *Cochlearia danica*, dandelion *Taraxacum officinale* agg., sticky groundsel *Senecio viscosus*, smooth sow-thistle *Sonchus oleraceus*, Oxford ragwort *Senecio squalidus* and common couch *Elytrigia repens*. A section of wall on the north side of Hard Ings Road (Target Note 4, Appendix 2; and Photo 3, Appendix 4) is covered with dense ivy *Hedera helix*.

3.2.3 Amenity Grassland

Mown amenity grassland is present at the front of a filling station on the north side of Hard Ings Road and also within Victoria Park (Target Note 8, Appendix 2). The grassland comprises typical species of managed amenity grassland including perennial rye-grass *Lolium perenne*, red fescue *Festuca rubra*, Yorkshire fog *Holcus lanatus*, dandelion, daisy *Bellis perennis*, ribwort plantain *Plantago lanceolata*, creeping buttercup *Ranunculus repens* and ragwort *Senecio jacobaea*.

3.2.4 Mixed Plantation Woodland

A belt of mixed plantation woodland lies on the eastern embankment of the A629 to the north of Beechcliffe Roundabout (Target Note 1, Appendix 2). The woodland is up to approximately 17 metres wide and extends approximately 130 metres north-to-south. It is understood that the trees were planted in 1986. Woody species present include Species present include Scot's pine *Pinus sylvestris*, European larch *Larix decidua*, grey willow *Salix cinerea*, pedunculate oak *Quercus robur*, sycamore *Acer pseudoplatanus*, ash *Fraxinus excelsior* and beech *Fagus sylvatica*. Ground flora comprises bramble *Rubus fruticosus* agg., red fescue, hogweed *Heracleum sphondylium*, dandelion, ground elder *Aegopodium podagraria*, common couch, bush vetch *Vicia sepium*, cock's-foot *Dactylis glomerata*, Yorkshire fog and lesser celandine *Ficaria verna*.

3.2.5 Broad-leaved Plantation Woodland

Belts of broad-leaved plantation woodland lie on the north side of Hard Ings Road (Target Note 2, Appendix 2) and also on the central part of Beechcliffe Roundabout. The trees on Beechcliffe

Roundabout appear to date from around 1986. The plantation to the east of Royd Way (Target Note 2, Appendix 2) contains around four trees which appear to pre-date the 1986 planting; beech, cherry *Prunus avium* and hawthorn *Crataegus monogyna* which appear to be approximately 40-70 years old.

Woody species present include sycamore, ash, beech, hawthorn, apple *Malus domestica*, pedunculate oak, field maple *Acer campestre*, lime *Tilia x Europaea*, bird cherry *Prunus padus*, cherry *Prunus avium* and cypress *Cupressus* sp. Ground flora comprises red fescue, creeping cinquefoil *Potentilla reptans*, ivy, common couch, cow parsley *Anthriscus sylvestris*, cock's-foot and curled dock *Rumex crispus*.

3.2.6 Tall Ruderal

A section of roadside embankment immediately east of Beechcliffe Roundabout comprises tall ruderal vegetation. Species present include cock's-foot, Yorkshire fog, false oat-grass *Arrhenatherum elatius*, broad-leaved dock *Rumex obtusifolius*, bramble, hogweed, greater willowherb *Epilobium hirsutum*, hardheads *Centaurea nigra* and prickly sow-thistle *Sonchus asper*.

3.2.7 Broad-leaved Trees

Aside from the plantation woodland areas; a small number of mature and young-mature broad-leaved trees are present adjacent to the scheme area (e.g. Target Notes 3, 4, 5, 6, 7, 8, Appendix 2). Species present include lime, sycamore, pedunculate oak, beech, hornbeam *Carpinus betulus* and horse chestnut *Aesculus hippocastanum*.

3.3 Protected / Notable Species

3.3.1 Amphibians

Based on field survey and analysis of aerial imagery and Ordnance Survey mapping, no standing waterbodies were identified within a 250 metre radius of the scheme area. Aerial imagery and Ordnance Survey mapping show two waterbodies within 500 metres of the scheme area; both are located approximately 450 metres north of Beechcliffe Roundabout (grid refs. SE06084267 and SE06224268). At the nearest point, both waterbodies are ~300 metres north of the scheme area.

Both waterbodies may be suitable to support breeding amphibians including great crested newts. It is noted that there appears to be abundant suitable terrestrial habitat in the immediate vicinity of both waterbodies; also there are barriers to dispersal between the waterbodies and the scheme area, i.e. a busy road and large buildings.

3.3.2 Reptiles

The urbanised infrastructure and the habitats within the project area are not conducive to the presence of reptiles. WYES do not have any recent records of reptiles from the area. Reptiles are highly unlikely to be present within the project working area and are not considered to be a constraint to the development.

3.3.3 Birds

Bird observations made within and adjacent to the scheme area included house sparrow, dunnock, long-tailed tit, blackbird, robin, wren and carrion crow. Of these birds, house sparrow and dunnock are listed on Section 41 of the NERC Act 2006 as Species of Principal Importance for the Conservation of Biodiversity in England. WYES provided numerous notable bird records within the surrounding area; many of which are expected to have been recorded within the farmland habitats and around River Aire to the north (>300m from the scheme area).

As shown in Appendix 3, several areas within the scheme area provide potentially suitable nesting habitat for common birds. All areas of woodland, trees, tall ruderal, dense ivy and ornamental shrubs provide potential nesting bird habitat. Birds could also potentially nest in buildings and walls, although potential nesting opportunities in the walls alongside Hard Ings Road appeared to be very limited.

3.3.4 *Bats*

In terms of potential bat roosting opportunities, the majority of trees within the scheme area are assessed as having zero or negligible potential to support bat roosts. Four trees have been identified as having 'low' bat roost potential due to features such as small cracks, splits and lifted bark: 2x ivy-clad beech trees on the northern side of Hard Ings Road (Target Note 4, Appendix 2); and two trees within Victoria Park to the south of Hard Ings Road (1x horse chestnut tree and 1x sycamore; Target Note 6, Appendix 2). Each of these four trees are set back several metres from Hard Ings Road and it is anticipated that it may be possible to retain them in situ.

In terms of bat foraging and commuting habitat, there is minimal suitable habitat within the scheme area; trees and plantation woodland provide small localised areas of low quality potential habitat. Disturbance levels within the scheme area are high due to high levels of vehicular traffic, noise and street lighting and this is anticipated to limit bat activity levels within the scheme area. Any bat activity is expected to be low and limited to species which are tolerant of urban disturbance (i.e., common and soprano pipistrelle). Occasional foraging and commuting passes of a low number of bats is the maximum level of activity expected.

3.3.5 *Other Fauna*

No evidence of badgers was observed during the survey. Hedgehog (S41 listed species) may occur within the scheme area, e.g. within the plantation woodland (Target Note 1, Appendix 2). Due to the urbanised environment and the nature of the habitats within the scheme area and the wider area, no other protected or notable fauna (badger, otter, brown hare etc) are likely to occur within the scheme area.

4 Conclusions and Recommendations

4.1 Conclusions

4.1.1 Designated Sites

Given the distances from designated sites and the nature of the scheme, no significant impacts on designated sites are predicted.

4.1.2 Habitats

The scheme will primarily affect habitats of negligible value, i.e. hard standing, walls and amenity grassland. However, the scheme could potentially result in the loss of the following habitats which are considered to be of value at up to the local level:

- Mixed and broad-leaved plantation woodland to the immediate east of the A629 (Target Note 1, Appendix 2) and north of Hard Ings Road (A650) (Target Note 2, Appendix 2). Up to approximately 0.35 hectares of plantation woodland may be directly lost.
- Broad-leaved trees. The scheme could potentially result in the loss of mature and young-mature trees adjacent to the scheme area (number unknown; likely to be fewer than 10).
- Ivy-covered wall. The scheme could potentially result in the loss of a section of ivy-clad wall adjacent to Hard Ings Road. Ivy can provide a valuable autumn nectar source for invertebrates.

4.1.3 Amphibians

Given the distance between the site and the nearest waterbodies (~300 metres) and the presence of barriers to dispersal (busy A629 dual-carriageway road and large warehouse) and the amount of habitat affected, it is considered very unlikely that great crested newts would be affected by the scheme. Therefore, no mitigation or compensation measures are considered necessary for great crested newts.

4.1.4 Birds

The scheme area is likely to support a limited range of common nesting birds in areas of woodland, trees, tall ruderal, dense ivy, ornamental shrubs and potentially in buildings and walls also. The site is not considered likely to be of significant value for Section 41 listed species or other notable bird species.

4.1.5 Bats

Four trees in close proximity to the scheme area have been identified as having 'low' bat roost potential due to features such as small cracks, splits and lifted bark: 2x ivy-clad beech trees on the northern side of Hard Ings Road; and two trees within Victoria Park. In terms of bat foraging and commuting habitat, the scheme area is likely to be of negligible value.

4.1.6 Other Fauna

The plantation woodland within the scheme area may be of local value for small numbers of hedgehog (S41 listed species). The scheme area is not likely to support other notable fauna such as badger, otter or brown hare.

4.2 Recommendations

4.2.1 Habitats

As far as possible, woodland and trees should be retained as part of the scheme layout. Where unavoidable, any loss of trees, woodland and ivy-clad walls should be compensated for with compensatory habitat creation (e.g. new woodland/hedgerow planting) or habitat improvement (e.g. reinstating suitable management on neglected habitats) on a minimum ratio of 3:1. Habitat

compensation should be implemented in close proximity to the scheme area if possible. However, it may be appropriate to provide the habitat compensation in the wider area depending on availability of suitable land (preferably within 1-2 km of the scheme area). It is noted that it may take several years for any new habitat creation to reach maturity; therefore it is likely that a short-term adverse effect on habitats will be unavoidable.

Any felled woody material should be used to create log-piles and/or brash piles within the scheme area, e.g. at the foot of embankments as habitat for invertebrates, birds and mammals such as the S41 listed species hedgehog. Felled woody material should not be chipped.

4.2.2 *Carbon Sequestration*

The plantation woodland within the scheme area provides a current 'carbon sink' as atmospheric CO₂ is sequestered into living material above and below ground. In order to avoid the loss of this 'carbon sink', it is recommended that any felled woody material should be used to create log-piles and/or brash piles and should not be chipped (see above). In addition, habitat compensation should be provided on a minimum ratio of 3:1 (see above).

4.2.3 *Birds*

The scheme area is likely to support a limited range of common nesting birds. As shown in Appendix 3, several areas within the scheme area provide potentially suitable nesting habitat for common birds. All areas of woodland, trees, tall ruderal, dense ivy and ornamental shrubs provide potential nesting bird habitat. Birds could also potentially nest in buildings and walls, although potential nesting opportunities in the walls alongside Hard Ings Road appeared to be very limited.

Where possible, ground works affected suitable nesting habitat should be undertaken outside the main nesting period of March-August inclusive. Where this is not possible, clearance of such areas should be preceded by a nesting bird check by a suitably qualified ecologist. If active bird nests are present, these should be retained in situ undisturbed until the nests are no longer active.

4.2.4 *Bats*

As far as possible, woodland and trees should be retained as part of the scheme layout. Regarding the four trees with 'low' bat roost potential (see target notes in Appendix 2), any felling or surgery should be preceded by detailed bat surveys involving either climb-and-inspect surveys by a Natural England licensed bat surveyor and/or dusk emergence / dawn return surveys. If bat roosts are present, a European Protected Species Mitigation licence may be required from Natural England, prior to felling or surgery.

4.2.5 *Other Fauna*

Any loss of woodland should be compensated for with compensatory habitat creation (see above). Any felled woody material should be used to create log-piles and/or brash piles within the scheme area, e.g. at the foot of embankments as habitat for hedgehogs and other species. Felled woody material should not be chipped.

Appendix 1. Legislation Context

European Protected Species (Including Bats, Great Crested Newt and Otter)

All British bat species, great crested newt and otter are fully protected through The Conservation of Habitats and Species Regulations 2010 as a European Protected Species (EPS). They also receive some protection through inclusion in Schedule 5 of the Wildlife and Countryside Act 1981 (as amended).

Under the legislation, it is an offence to deliberately capture, injure or kill a bat, great crested newt or otter. It is an offence to damage or destroy a breeding site or resting place of a bat, great crested newt or otter. It is also an offence to intentionally or recklessly disturb a bat, great crested newt or otter while it is occupying a structure or place which it uses for shelter or protection; or obstruct access to any structure or place which it uses for that purpose.

It is also an offence to deliberately disturb a bat, great crested newt or otter; in particular any disturbance which is likely (a) to impair their ability - (i) to survive, to breed or reproduce, or to rear or nurture their young, or (ii) in the case of animals of a hibernating or migratory species, to hibernate or migrate; or (b) to affect significantly the local distribution or abundance of the species to which they belong.

The 'appropriate authority' (Natural England in England) has powers to issue licences for various purposes including - (a) scientific or educational purposes... and (e) preserving public health or public safety or other imperative reasons of overriding public interest including those of a social or economic nature and beneficial consequences of primary importance for the environment. The appropriate authority shall not grant a licence under this regulation unless they are satisfied - (a) that there is no satisfactory alternative, and (b) that the action authorised will not be detrimental to the maintenance of the population of the species concerned at a favourable conservation status in their natural range. It is an offence for any person authorised by virtue of a licence to which this paragraph applies to contravene or fail to comply with any condition which the licence requires him to comply with.

Great crested newt, otter and several species of bat including brown long-eared and soprano pipistrelle *Pipistrellus pygmaeus* are identified as UK Biodiversity Action Plan (BAP) priority species.

Nesting Birds

All wild birds in the UK are protected under Section 1 of the Wildlife and Countryside Act 1981 (as amended) which makes it an offence to intentionally kill, injure or take any wild bird or take, damage or destroy the nest (whilst being built or in use) or its eggs. Bird species listed in Schedule 1 of the 1981 Act, receive further protection which makes it an offence to intentionally or recklessly disturb these species while building a nest or in, on or near a nest containing eggs or young; or to disturb dependent young of such a bird.

Appendix 2. Phase 1 Habitat Map and Target Notes

Target Notes

Target Note	Description
1	Belt of mixed plantation woodland on roadside embankment. Trees understood to have been planted around 1986. Species present include <i>Pinus sylvestris</i> , <i>Larix decidua</i> , <i>Salix cinerea</i> , <i>Quercus robur</i> , <i>Acer pseudoplatanus</i> , <i>Fraxinus excelsior</i> and <i>Fagus sylvatica</i> . All trees have negligible or zero bat roost potential. Ground flora comprises <i>Rubus fruticosus</i> agg., <i>Festuca rubra</i> , <i>Heracleum sphondylium</i> , <i>Taraxacum officinale</i> , <i>Aegopodium podagraria</i> , <i>Elytrigia repens</i> , <i>Vicia sepium</i> , <i>Dactylis glomerata</i> , <i>Holcus lanatus</i> and <i>Ficaria verna</i> .
2	Belt of broad-leaved plantation woodland on roadside embankment. Most trees appear to be <30 years old but ~4 trees ~40-70 years old. All trees have negligible or zero bat roost potential. Species present include <i>Crataegus monogyna</i> , <i>Malus domestica</i> , <i>Quercus robur</i> , <i>Acer pseudoplatanus</i> , <i>Prunus avium</i> , <i>Fraxinus excelsior</i> , <i>Cupressus</i> sp. and <i>Fagus sylvatica</i> . Ground flora comprises <i>Festuca rubra</i> , <i>Potentilla reptans</i> , <i>Hedera helix</i> , <i>Elytrigia repens</i> and <i>Rumex crispus</i> .
3	2x mature lime trees (negligible bat roost potential) growing up-against south side of roadside wall; 2x mature / young-mature beech trees (negligible bat roost potential) ~2m south of roadside wall.
4	2x young-mature beech trees with ivy cover (low bat roost potential); 1x young-mature grey willow (multi-stemmed tree with negligible bat roost potential); and dense ivy cover on roadside wall.
5	Area of ornamental planting (nesting bird habitat) comprising Portugal laurel; young-mature hornbeams and sycamore.
6	1x mature horse chestnut (low bat roost potential); and 1x mature sycamore (low bat roost potential).
7	3x young-mature trees growing up against south side of roadside wall: 2x hornbeam; 1x grey willow.
8	Mature and semi-mature trees in Victoria Park. Within 10 metres of Hard Ings Road: 1x mature beech and 2x mature lime trees with negligible bat roost potential; 1x young-mature ash tree with zero bat roost potential.

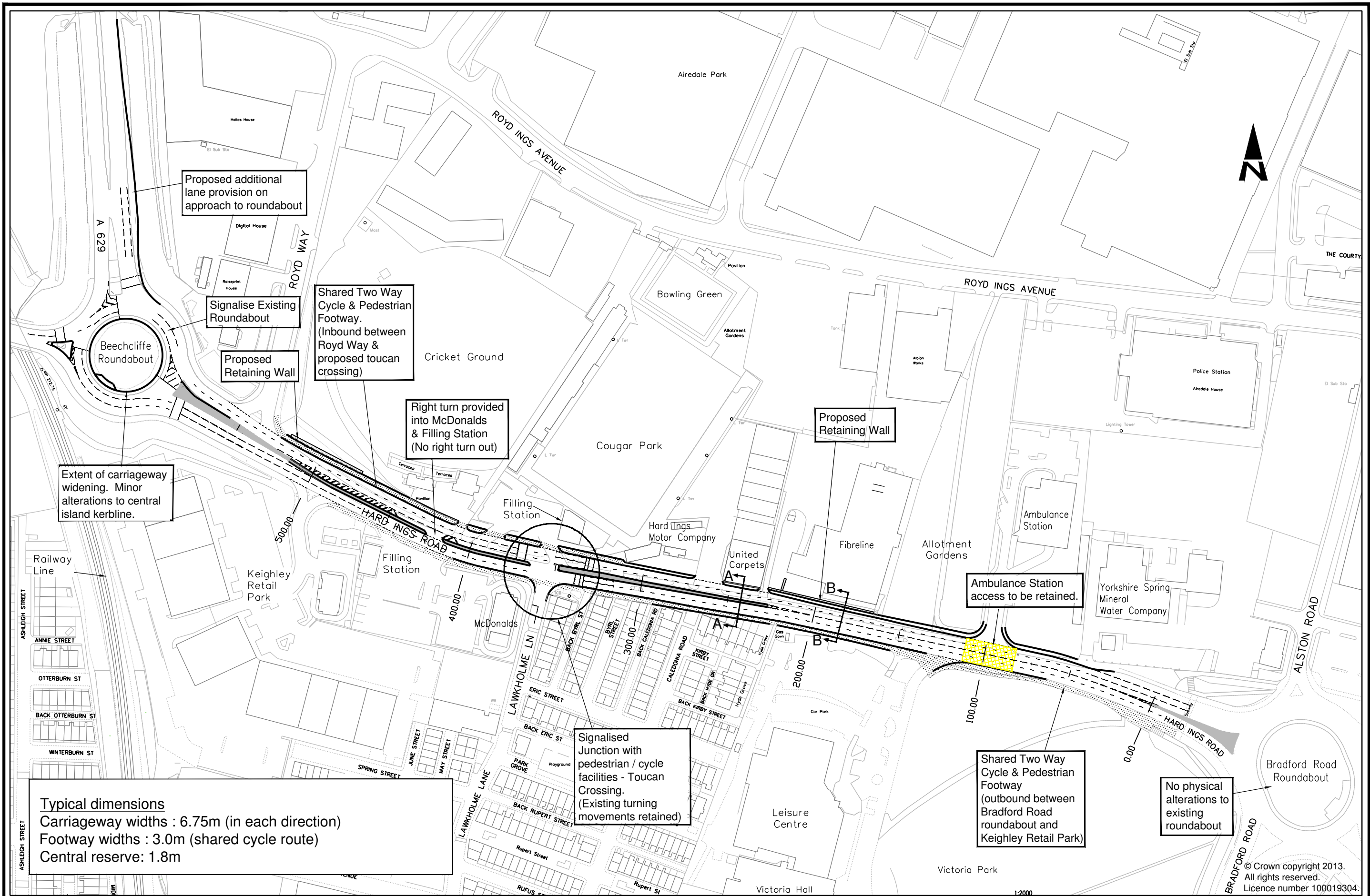

Extent of carriageway widening. Minor alterations to central island kerbline.

Proposed additional lane provision on approach to roundabout

Signalise Existing Roundabout

Proposed Retaining Wall

Shared Two Way Cycle & Pedestrian Footway. (Inbound between Royd Way & proposed toucan crossing)

Right turn provided into McDonalds & Filling Station (No right turn out)

Proposed Retaining Wall

Ambulance Station access to be retained.

Signalised Junction with pedestrian / cycle facilities - Toucan Crossing. (Existing turning movements retained)

Shared Two Way Cycle & Pedestrian Footway (outbound between Bradford Road roundabout and Keighley Retail Park)

No physical alterations to existing roundabout

Typical dimensions
 Carriageway widths : 6.75m (in each direction)
 Footway widths : 3.0m (shared cycle route)
 Central reserve: 1.8m

© Crown copyright 2013. All rights reserved. Licence number 100019304.

City of Bradford MDC www.bradford.gov.uk Department of Regeneration and Culture Strategic Director: Mike Cowlam BA (Hons) Town and Country Planning, Dip M, Dip EPP	Design Office Transportation and Highways Service Highways Design Unit 2nd Floor South Jacobs Well Nelson Street Bradford BD1 5RW	Project HARD INGS ROAD IMPROVEMENTS	Design SA	Drawn SA	Checked CEY	Released Date 12/2015	Drawing Title SCHEME LAYOUT
	Client A Original	SA 02.12.15	Engineer to Contract	Scale(s) @ A3 1:2000	Approved	Date	Drawing No. PTH/HD/103197/MS-1A
	Revision	Inits Date	Date	Date	Date	Date	Date

Appendix 3. Nesting Bird Constraints Plan

Yellow shading indicates areas most likely to support bird nests



Appendix 4. Photographs

Photo 1. Looking west through Victoria Park (see Target Note 8, Appendix 2)



Photo 2. Looking west to area of suitable nesting bird habitat (Portugal laurel) (see Target Note 5, Appendix 2)



Photo 3. Looking north across Hard Ings Road to 2x beech trees with low bat roost potential (Target Note 4, Appendix 2)



Photo 4. Looking west along Hard Ings Road (beech tree and 2x lime trees visible – see Target Note 3, Appendix 2)



Photo 5. Looking south-east from junction of Royd Way and Hard Ings Road (broad-leaved plantation woodland – see Target Note 2, Appendix 2)



Photo 6. Looking north from east side of Beechcliffe Roundabout across tall ruderal vegetation to mixed plantation woodland – see Target Note 1, Appendix 2). A629 traffic visible on left



Appendix 5. Information Provided by WYES



West Yorkshire
**Ecology
Service**

West Yorkshire Ecology Service
Registry of Deeds
Newstead Road
Wakefield
WF1 2DE
Tel/Fax: 01924 306 793
Email: ecology@wyjs.org.uk

ECOLOGICAL RECORDS SEARCH

FOR

**HARDINGS ROAD,
KEIGHLEY**

Ref No:- 20160216 B588 LP

Date: 02/03/2016

Prepared For Ryan Knight

Quants Environmental Ltd

Table of Contents

1	Introduction.....	1
2	Species.....	1
2.1	Sensitive Species Records.....	1
2.1.1	Badgers	1
3	Designated sites.....	1
3.1	Internationally Designated site	1
3.1.1	Special Protection Areas.....	1
3.1.2	Special Areas of Conservation.....	1
3.2	Nationally Designated Sites.....	1
3.2.1	Sites of Special Scientific Interest	1
3.3	Locally Designated Sites	2
3.3.1	Sites of Ecological or Geological Importance.....	2
3.3.2	Local Wildlife Sites.....	2
3.3.3	Bradford Wildlife Areas	2
3.3.4	Local Nature Reserves	4
3.3.5	Local Geological Sites	4
4	Habitats	6
4.1	UK Priority Habitats	6

List of Figures

Figure 1 – Species and Designated Sites.....	5
Figure 2 – UK Priority Habitats	7

List of Appendices

Appendix A – Explanation of Species Designations	i
Appendix B – Designated Site Citations	iv
Appendix C – Species Records	v

1 Introduction

This report provides a summary of the protected and notable species, habitats and designated sites information held by West Yorkshire Ecology Service (WYES) within 2km of grid reference SE 06525 42046.

The information within this report is supplied subject to WYES's 'Terms and Conditions', which can be viewed on the WYES website (<http://www.ecology.wyjs.org.uk>).

2 Species

Please see Appendix C for records held by WYES within your defined search area.

2.1 SENSITIVE SPECIES RECORDS

2.1.1 Badgers

There is known badger activity in this area.

Badgers are protected under the Protection of Badgers Act 1992 and offences can result from both reckless and deliberate damage, disturbance or destruction.

Please see the separate confidential badger map for more information.

BADGERS ARE STILL BEING PERSECUTED, PLEASE DO NOT PASS THESE RECORDS ONTO THIRD PARTIES (INCLUDING SUPPORTING DOCUMENTATION FOR PLANNING APPLICATIONS).

3 Designated sites

3.1 INTERNATIONALLY DESIGNATED SITE

3.1.1 Special Protection Areas

There are no Special Protection Areas within your search area.

3.1.2 Special Areas of Conservation

There are no Special Areas of Conservation within your search area.

3.2 NATIONALLY DESIGNATED SITES

3.2.1 Sites of Special Scientific Interest

There are no Sites of Special Scientific Interest within the search area.

3.3 LOCALLY DESIGNATED SITES

3.3.1 Sites of Ecological or Geological Importance

Sites of Ecological or Geological Importance' (SEGI) are areas identified by the relevant local authority as being important for their flora, fauna, geological or physiological features. They are of county wide importance. Sites recorded include:

- Beechcliffe Ings
- Leeds-Liverpool Canal (part Leeds)

Citations for SEGIs are provided in Appendix B.

3.3.2 Local Wildlife Sites

West Yorkshire is currently going through a process of merging 2nd and 3rd tier local sites into a single Local Wildlife Site (LWS) designation. Sites should be given the same protection as SEGIs, as set out in UDPs/LDFs.

- Elam Wood
- How Beck Wood
- Low Wood
- Park Wood
- Stockbridge Nature Reserve

Citations for LWS are provided in Appendix B.

Please refer to the link below for the West Yorkshire Local Wildlife Site Selection Criteria.
<http://www.ecology.wyjs.org.uk/wyjs-ecology-ls.asp>

3.3.3 Bradford Wildlife Areas

Bradford Wildlife Areas (BWA) are third tier sites, designated by the local authority on the basis of their amenity value. Many of these sites have recently been resurveyed and are being assessed against new Local Wildlife Sites (LWS) criteria. Further citations and species lists for specific sites can be supplied on request.

 Denotes sites with no public access

NATURE RESERVES

STOCKBRIDGE NATURE RESERVE

SE 072423

Developed as a prime bird watching site by Bradford Ornithological Group; wetland habitat with hide facilities. Access by BOG members only.

WETLANDS

BEECHCLIFFE OX-BOW LAKE 

SE 061427

Wetland and associated damp grassland at edge of industrial estate and adjacent to River Aire. Good for waders such as lapwing (*Vanellus vanellus*) and curlew (*Numenius arquata*)
No public access.

WOODLANDS

ELAM WOOD, Keighley

SE 065433

Probably an ancient woodland. Important wildlife corridor alongside Leeds-Liverpool Canal, with Low Wood and Spring Crag/Alder Carr Wood. Council owned - open access.

LOW WOOD, Keighley

SE 058438

Valuable woodland resource, owned and managed by the Council's Recreation Division and Yorkshire Wildlife Trust; supports varied wildlife, including protected species. Remnant of ancient woodland. Tawny owl (*Strix aluco*), redstart (*Phoenicurus phoenicurus*), chiffchaff (*Phylloscopus collybita*), wood warbler (*Phylloscopus sibilatrix*) and willow warbler (*Phylloscopus trochilus*) recorded.

PARK WOOD, Keighley

SE 070409

Mature woodland (part ancient woodland) south-east of Keighley town centre, extended by recent planting of young trees. Good regeneration in oak woodland, beech woodland has poor understorey. Part privately owned, part council owned; public footpath through site.

RIDDLESDEN HOSPITAL (Disused)

SE 085422

Overgrown woodland containing some ornamental species, also an area of prime beech woodland with stream and carpeted with bluebells in spring. Good for birds and other wildlife species. Privately owned, some public access negotiated as part of planning permission.

LINEAR HABITATS/WILDLIFE CORRIDORS

NORTH BECK, Keighley

SE 052409

Wildlife corridor linking open countryside to the centre of Keighley. Good for birdlife. Public access along footpath.

See Figure 1 for Bradford Wildlife Habitat Network data.

Wildlife Habitat Network data for Bradford can be found on the links below:

http://www.bradford.gov.uk/bmdc/the_environment/planning_service/unitary_development_plan/access_the_replacement_UDP

“Look at the adopted maps”

“Accept terms and conditions”

Not currently mapped. (Draft for LDF produced by WYE)

Replacement UDP (Oct 2005)

http://www.bradford.gov.uk/bmdc/the_environment/planning_service/unitary_development_plan/Replacement+Unitary+Development+Plan+for+the+Bradford+District.+Adopted+October+2005

Download “Policy Framework” see page 215 policy NE 13

3.3.4 Local Nature Reserves

There are no Local Nature Reserves (LNR) within your search area.

3.3.5 Local Geological Sites

There are no Local Geological Sites (Regionally Important Geological Site (RIGS)) within your search area.

Figure 1 – Species and Designated Sites



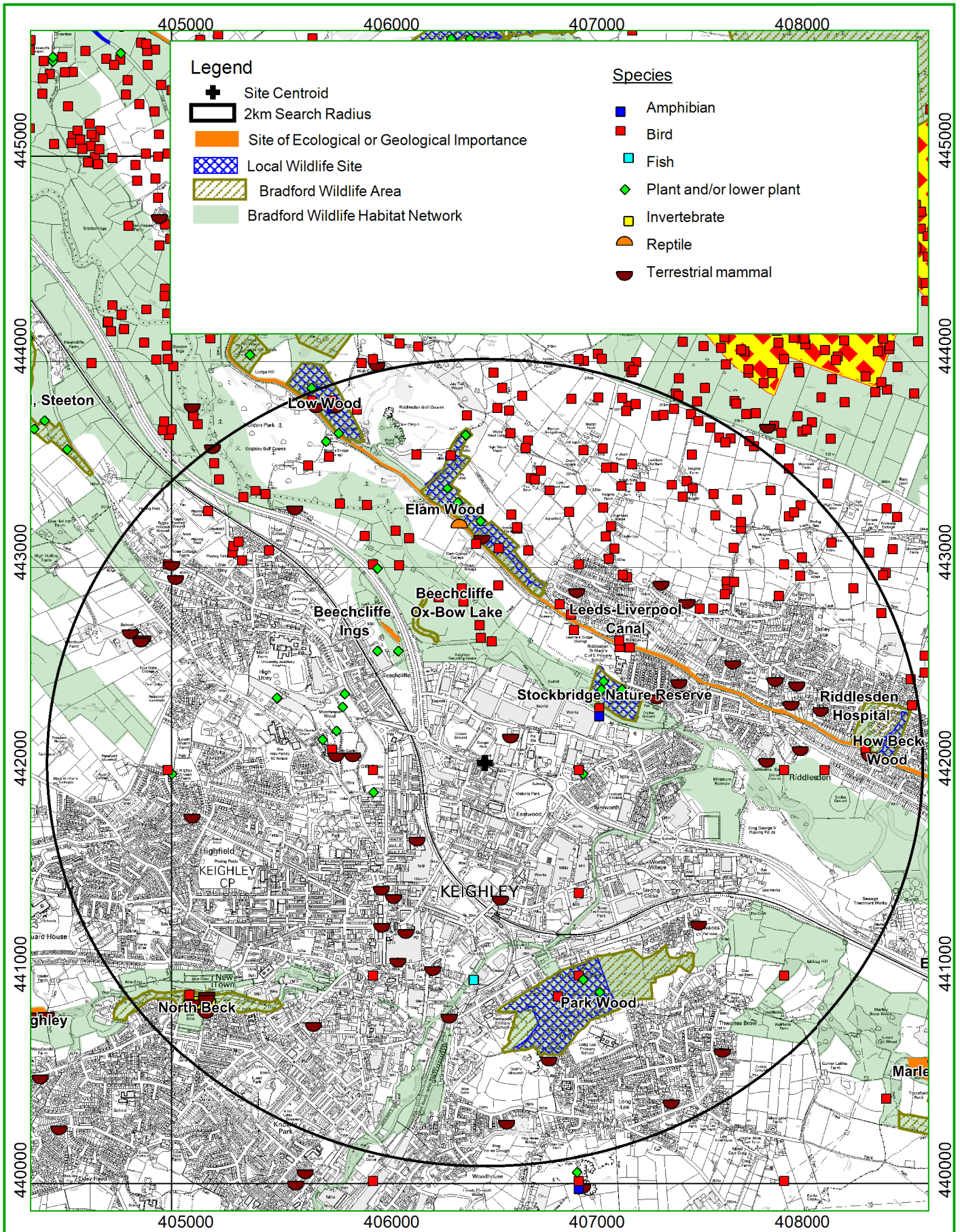

Legend

- Site Centroid
- 2km Search Radius
- Site of Ecological or Geological Importance
- Local Wildlife Site
- Bradford Wildlife Area
- Bradford Wildlife Habitat Network

Species

- Amphibian
- Bird
- Fish
- Plant and/or lower plant
- Invertebrate
- Reptile
- Terrestrial mammal

Unauthorised reproduction infringes Crown copyright. Copying, sub-licensing, distribution, sale or any other use is strictly prohibited by any third party. Reproduced from the Ordnance Survey digital mapping with the permission of Ordnance Survey on behalf of Her Majesty's Stationery Office. (c) Crown copyright. OS Licence number: WMDC100019574.



Scale 1:25000
At Size A4



**FIGURE 1:
SPECIES &
DESIGNATED
SITES**

4 Habitats

4.1 UK PRIORITY HABITATS

Natural England (English Nature) creates, maintains and publishes priority habitat inventories across the UK. These have been reproduced on Figure 2 with permission from Natural England. The terms of use for Natural England's Information and Data can be found at the following web site: <http://www.naturalengland.org.uk/copyright/>.

Please note that WYE has combined priority main habitats with those classified as candidate habitats. Please see the metadata description sheet produced by Natural England for further information. Detailed habitats can be supplied upon request.





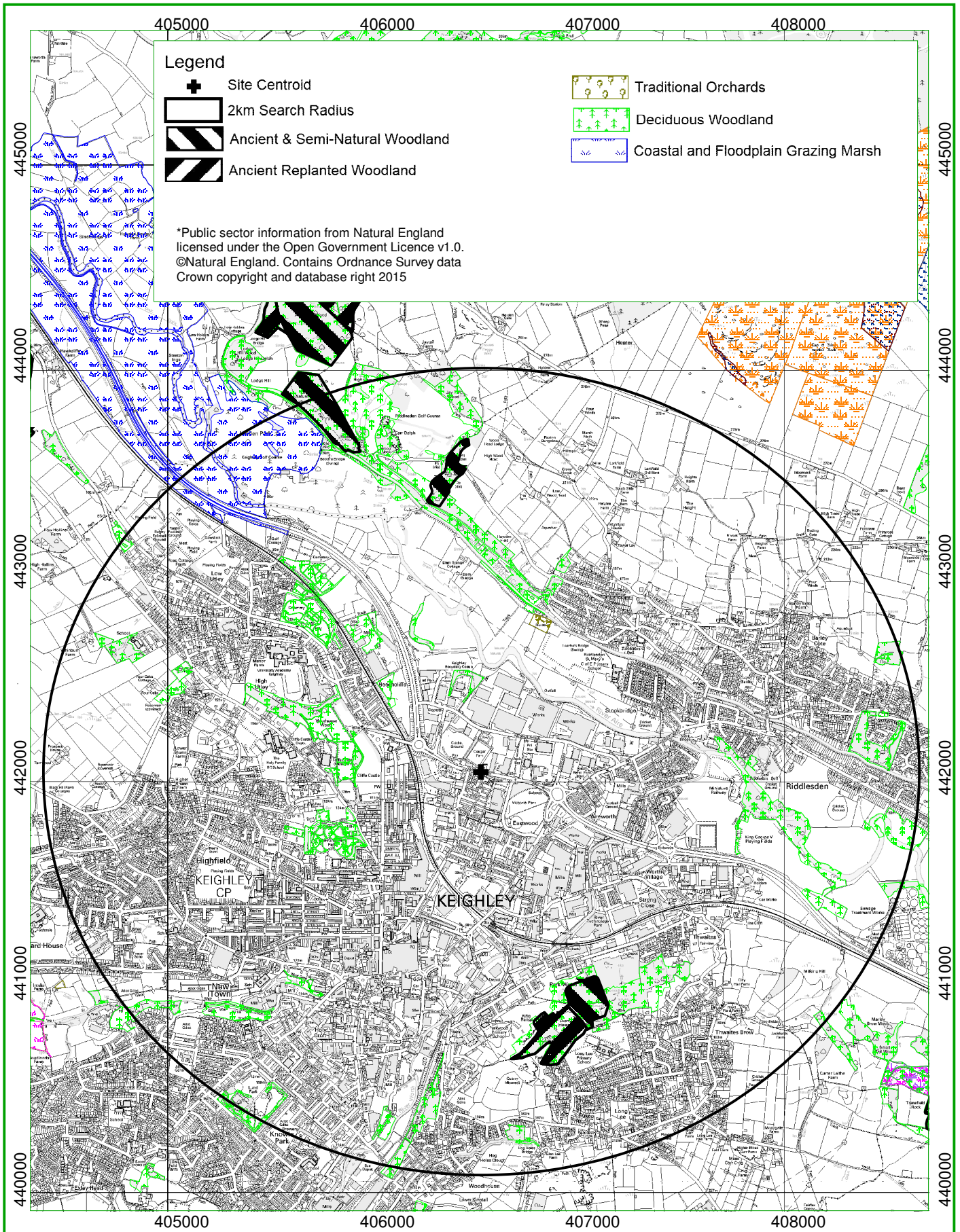

The habitats identified within the search area are:

- Ancient & Semi-Natural Woodland
- Ancient Replanted Woodland
- Deciduous woodland
- Traditional Orchards
- Coastal Floodplain and Grazing Marsh

Figure 2 – UK Priority Habitats



Legend

-  Site Centroid
-  2km Search Radius
-  Ancient & Semi-Natural Woodland
-  Ancient Replanted Woodland
-  Traditional Orchards
-  Deciduous Woodland
-  Coastal and Floodplain Grazing Marsh

*Public sector information from Natural England licensed under the Open Government Licence v1.0.
 ©Natural England. Contains Ordnance Survey data
 Crown copyright and database right 2015

Unauthorised reproduction infringes Crown copyright. Copying, sub-licensing, distribution, sale or any other use is strictly prohibited by any third party. Reproduced from the Ordnance Survey digital mapping with the permission of Ordnance Survey on behalf of Her Majesty's Stationery Office. (c) Crown copyright. OS Licence number: WMDC100019574.



Scale 1: 25000
 At Size A4



West Yorkshire Ecology Service

**FIGURE 2:
 UK
 PRIORITY
 HABITATS**

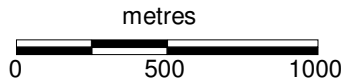

Appendix A. Explanation of Species Designations

Wildlife and Countryside Act 1981 – main designations cited

Abbreviation	Full Name	Description	Offences include, but not limited to
Sch1_part1	Schedule 1, Part 1	Birds which are protected by special penalties at all times	<ul style="list-style-type: none"> disturb any specially protected bird while it is building its nest; disturb any specially protected bird while it is near a nest containing eggs or young; or disturb the young of any of these birds before they are wholly independent.
Sch1_part2	Schedule 1, Part 2	Birds which are protected by special penalties during the close season	
Sch5	Schedule 5	Animals which are protected	<ul style="list-style-type: none"> intentional or reckless killing, injuring, taking; damage to, destruction of, obstruction of access to any structure or place used by a scheduled animal for shelter or protection; and disturbance of animal occupying such a structure or place.
Sch5_sect9.1	Schedule 5, Section 9(1)	Animals which are protected from killing and/or taking	<ul style="list-style-type: none"> intentional killing, injuring and/or taking <p>NB: certain species are only partly protected by this section. Check primary legislation for details.</p>
Sch5_sect9.5	Schedule 5, Section 9(5)	Animals which are protected from sale	<ul style="list-style-type: none"> selling, offering for sale, possessing or transporting for the purpose of sale (live or dead animal, part or derivative); and advertising for buying or selling such things
Sch8	Schedule 8	Plants which are fully protected	<ul style="list-style-type: none"> pick, uproot, trade in, or possess (for the purposes of trade).
Sch8_sect 13.2 (sale only)	Schedule 8, Sections 13(2a+2b)	Plants which are protected from sale only	<ul style="list-style-type: none"> selling, offering for sale, possessing or transporting for the purpose of sale, any plant (live or dead, part or derivative) + advertising for buying or selling such things

Sch9_part1	Schedule 9, Part 1	Animals which are established in the wild.	<ul style="list-style-type: none"> the release of animals and planting of plants listed in Schedule 9. the above offences can be made legal through the granting of licences by the appropriate authorities. NB: <i>Tyto alba</i> refers to captive bred only.
Sch9_part2	Schedule 9, Part 2	Plants which are established in the wild.	

Biodiversity Action Plans

Abbreviation	Full Name
UKBAP	UK Biodiversity Action Plan
WYBAP	West Yorkshire Priority Species List
Bradford BAP	Bradford Biodiversity Action Plan
Calderdale BAP	Calderdale Biodiversity Action Plan
Kirklees BAP	Kirklees Biodiversity Action Plan
Leeds BAP	Leeds Biodiversity Action Plan
Wakefield BAP	Wakefield Biodiversity Action Plan

Birds of Conservation Concern (BOCC) 2009

List	Description
Red	High conservation concern
Amber	Medium conservation concern

Red Data Book Categories (Based on ICUN Guidelines)

Abbreviation	Full Name
EX	Extinct
EW	Extinct in the Wild
CR	Critically Endangered
VU	Vulnerable
NT	Near Threatened
LC	Least Concern
DD	Data Deficient
NE	Not Evaluated

Nationally Notable Invertebrates:

Abbreviation	Full Name	Description
NR	Nationally Rare	found in 15 or fewer hectads
Notable or NS	Nationally Notable or Nationally Scarce	found in between 16 and 100 hectads
Notable A	Nationally Notable A	found in 16 to 30 hectads
Notable B	Nationally Notable B	found in between 31 and 100 hectads

References

Biodiversity Reporting and Information Group, (2007) *Report on the Species and Habitat Review*, UK Biodiversity Partnership. <http://www.ukbap.org.uk/>.

Bratton, J.H. (ed), (1991) *British Red Data Books: 3. Invertebrates other than insects*. JNCC, Peterborough.

BTO, et al (2009) *The Birds of Conservation Concern 3*. British Trust for Ornithology. <http://www.bto.org/psob/index.htm>.

Calderdale Biodiversity Action Plan Technical Group (2008) *Calderdale Local Biodiversity Plan: Review of Species and habitats*, Calderdale Biodiversity Action Plan Technical Group, Calderdale.

Cheffings, C. and Farrell, L. (Editors), (2005) *The Vascular Plant Red Data List for Great Britain*, ISSN 1473-0154.

City of Bradford MDC, (2003), *A Local Biodiversity Action Plan for the Bradford District (Draft)*, City of Bradford MDC, Bradford.

IUCN, (2004) *Guidelines for using the IUCN. Red List categories and criteria*. IUCN,. Gland and Cambridge

J. C. Lavin & G.T.D. Wilmore (1994) , *The West Yorkshire Plant Atlas*, City of Bradford Metropolitan Council, Bradford.

Kirklees Metropolitan Council (2008) *Kirklees Biodiversity Action Plan*, Kirklees Metropolitan Council, Kirklees.

Leeds BAP Steering Group, (2000) *Biodiversity Action Plan For Leeds*, Leeds City Council, Leeds.

Shirt, D. B. (Ed.), (1987) *British Red Data Books : 2 : Insects*. Peterborough: NCC.

Wakefield Biodiversity Group, (2001) *Wakefield District Local Biodiversity Report*, Wakefield MDC, Wakefield.

West Yorkshire Biodiversity Action Partnership (2009), *West Yorkshire Priority Species List*, West Yorkshire Ecology, Wakefield.

Appendix B. Designated Site Citations

Appendix C. Species Records

Grid Ref	Common Name	Latin Name	Taxon Group	Date	Record Type	Abundance	Designation	Distance from site centroid (m)
SE058438	Common Toad	<i>Bufo bufo</i>	amphibian	Unknown	field record		Sch5_sect9.5b; UKBAP; WYBAP	1,896
SE058438	Common Frog	<i>Rana temporaria</i>	amphibian	Unknown	field record		Sch5_sect9.5b; WYBAP	1,896
SE071423	Common Frog	<i>Rana temporaria</i>	amphibian	11/09/2012	field observation		Sch5_sect9.5b; WYBAP	627
SE0644042822	Common Sandpiper	<i>Actitis hypoleucos</i>	bird	29/04/2013	field record	1 Count	BoCC:Amber	780
SE0651942707	Common Sandpiper	<i>Actitis hypoleucos</i>	bird	29/04/2013	field record	1 Count	BoCC:Amber	661
SE0642	Skylark	<i>Alauda arvensis</i>	bird	1970 - 1988	field record		BoCC:Red; UKBAP; WYBAP	526
SE0643	Skylark	<i>Alauda arvensis</i>	bird	1970 - 1988	field record		BoCC:Red; UKBAP; WYBAP	1,088
SE0741	Skylark	<i>Alauda arvensis</i>	bird	1970 - 1988	field record		BoCC:Red; UKBAP; WYBAP	1,148
SE0743	Skylark	<i>Alauda arvensis</i>	bird	1970 - 1988	field record		BoCC:Red; UKBAP; WYBAP	1,065
SE0772142919	Skylark	<i>Alauda arvensis</i>	bird	14/06/2013	field record	1 Count	BoCC:Red; UKBAP; WYBAP	1,478
SE0842	Skylark	<i>Alauda arvensis</i>	bird	1970 - 1988	field record		BoCC:Red; UKBAP; WYBAP	1,472

Grid Ref	Common Name	Latin Name	Taxon Group	Date	Record Type	Abundance	Designation	Distance from site centroid (m)
SE0843	Skylark	<i>Alauda arvensis</i>	bird	1970 - 1988	field record		BoCC:Red; UKBAP; WYBAP	1,753
SE058438	Kingfisher	<i>Alcedo atthis</i>	bird	1970 - 1988	field record		Sch1_part1; BoCC:Amber	1,896
SE0652442646	Kingfisher	<i>Alcedo atthis</i>	bird	20/06/2013	field record	1 Count	Sch1_part1; BoCC:Amber	600
SE0842	Mallard	<i>Anas platyrhynchos</i>	bird	1970 - 1988	field record		BoCC:Amber	1,472
SE0522643495	Meadow Pipit	<i>Anthus pratensis</i>	bird	29/04/2013	field record	3 Count	BoCC:Amber	1,943
SE0617643129	Meadow Pipit	<i>Anthus pratensis</i>	bird	29/04/2013	field record	3 Count	BoCC:Amber	1,137
SE0621143536	Meadow Pipit	<i>Anthus pratensis</i>	bird	24/04/2013	field record	3 Count	BoCC:Amber	1,522
SE0643	Meadow Pipit	<i>Anthus pratensis</i>	bird	1970 - 1988	field record		BoCC:Amber	1,088
SE0662843861	Meadow Pipit	<i>Anthus pratensis</i>	bird	24/04/2013	field record	11 Count	BoCC:Amber	1,817
SE0701143363	Meadow Pipit	<i>Anthus pratensis</i>	bird	12/06/2013	field record	1 Count	BoCC:Amber	1,403
SE0711743566	Meadow Pipit	<i>Anthus pratensis</i>	bird	23/04/2013	field record	2 Count	BoCC:Amber	1,630
SE0713143137	Meadow Pipit	<i>Anthus pratensis</i>	bird	14/06/2013	field record	1 Count	BoCC:Amber	1,247
SE0716843474	Meadow Pipit	<i>Anthus pratensis</i>	bird	23/04/2013	field record	2 Count	BoCC:Amber	1,565
SE0752643408	Meadow Pipit	<i>Anthus pratensis</i>	bird	14/06/2013	field record	1 Count	BoCC:Amber	1,688
SE0765643341	Meadow Pipit	<i>Anthus pratensis</i>	bird	14/06/2013	field record	1 Count	BoCC:Amber	1,717
SE0772242881	Meadow Pipit	<i>Anthus pratensis</i>	bird	23/04/2013	field record	1 Count	BoCC:Amber	1,456
SE0823543107	Meadow Pipit	<i>Anthus pratensis</i>	bird	12/06/2013	field record	1 Count	BoCC:Amber	2,008
SE0842	Meadow Pipit	<i>Anthus pratensis</i>	bird	1970 - 1988	field record		BoCC:Amber	1,472
SE058438	Tree Pipit	<i>Anthus trivialis</i>	bird	1970 - 1988	field record		BoCC:Red; UKBAP; WYBAP	1,896
SE0643	Tree Pipit	<i>Anthus trivialis</i>	bird	1970 - 1988	field record		BoCC:Red; UKBAP; WYBAP	1,088

Grid Ref	Common Name	Latin Name	Taxon Group	Date	Record Type	Abundance	Designation	Distance from site centroid (m)
SE0542	Swift	<i>Apus apus</i>	bird	1970 - 1988	field record		BoCC:Amber; WYBAP	1,521
SE058421	Swift	<i>Apus apus</i>	bird	19/06/2010	field record	1 Count of Adult	BoCC:Amber; WYBAP	725
SE058438	Swift	<i>Apus apus</i>	bird	1970 - 1988	field record		BoCC:Amber; WYBAP	1,896
SE0641	Swift	<i>Apus apus</i>	bird	1970 - 1988	field record		BoCC:Amber; WYBAP	1,169
SE0842	Swift	<i>Apus apus</i>	bird	1970 - 1988	field record		BoCC:Amber; WYBAP	1,472
SE0842	Swift	<i>Apus apus</i>	bird	2008	field record		BoCC:Amber; WYBAP	1,472
SE0670143180	Linnet	<i>Carduelis cannabina</i>	bird	12/06/2013	field record	2 Count	BoCC:Red; UKBAP; WYBAP	1,147
SE0711943276	Linnet	<i>Carduelis cannabina</i>	bird	14/06/2013	field record	3 Count	BoCC:Red; UKBAP; WYBAP	1,365
SE0842	Stock Dove	<i>Columba oenas</i>	bird	1970 - 1988	field record		BoCC:Amber	1,472
SE0804943253	Quail	<i>Coturnix coturnix</i>	bird	12/06/2013	field record	1 Count of Male	Sch1_part1; BoCC:Amber	1,940
SE058438	Cuckoo	<i>Cuculus canorus</i>	bird	1970 - 1988	field record		BoCC:Red; UKBAP; WYBAP	1,896
SE058438	House Martin	<i>Delichon urbica</i>	bird	1970 - 1988	field record		BoCC:Amber; WYBAP	1,896
SE0643	House Martin	<i>Delichon urbica</i>	bird	1970 - 1988	field record		BoCC:Amber; WYBAP	1,088
SE0842	House Martin	<i>Delichon urbica</i>	bird	1970 - 1988	field record		BoCC:Amber; WYBAP	1,472

Grid Ref	Common Name	Latin Name	Taxon Group	Date	Record Type	Abundance	Designation	Distance from site centroid (m)
SE058438	Lesser Spotted Woodpecker	<i>Dendrocopos minor</i>	bird	1970 - 1988	field record		BoCC:Red; UKBAP; WYBAP	1,896
SE058438	Yellowhammer	<i>Emberiza citrinella</i>	bird	1970 - 1988	field record		BoCC:Red; UKBAP; WYBAP; Bradford BAP	1,896
SE0643	Yellowhammer	<i>Emberiza citrinella</i>	bird	1970 - 1988	field record		BoCC:Red; UKBAP; WYBAP; Bradford BAP	1,088
SE0841	Yellowhammer	<i>Emberiza citrinella</i>	bird	1970 - 1988	field record		BoCC:Red; UKBAP; WYBAP; Bradford BAP	1,805
SE0842	Yellowhammer	<i>Emberiza citrinella</i>	bird	1970 - 1988	field record		BoCC:Red; UKBAP; WYBAP; Bradford BAP	1,472
SE0543	Reed Bunting	<i>Emberiza schoeniclus</i>	bird	1970 - 1988	field record		BoCC:Amber; UKBAP; WYBAP	1,795
SE0612742996	Reed Bunting	<i>Emberiza schoeniclus</i>	bird	20/06/2013	field record	1 Count	BoCC:Amber; UKBAP; WYBAP	1,029
SE0645743727	Reed Bunting	<i>Emberiza schoeniclus</i>	bird	12/06/2013	field record	1 Count	BoCC:Amber; UKBAP; WYBAP	1,682
SE070414	Peregrine	<i>Falco peregrinus</i>	bird	2008	field record		Sch1_part1; WYBAP	801
SE070414	Peregrine	<i>Falco peregrinus</i>	bird	2009	field record		Sch1_part1; WYBAP	801

Grid Ref	Common Name	Latin Name	Taxon Group	Date	Record Type	Abundance	Designation	Distance from site centroid (m)
SE070414	Peregrine	<i>Falco peregrinus</i>	bird	2010	field record		Sch1_part1; WYBAP	801
SE0542	Kestrel	<i>Falco tinnunculus</i>	bird	1970 - 1988	field record		BoCC:Amber; WYBAP	1,521
SE058438	Kestrel	<i>Falco tinnunculus</i>	bird	1970 - 1988	field record		BoCC:Amber; WYBAP	1,896
SE0741	Kestrel	<i>Falco tinnunculus</i>	bird	1970 - 1988	field record		BoCC:Amber; WYBAP	1,148
SE082420	Kestrel	<i>Falco tinnunculus</i>	bird	09/01/2007	Casualty	1 Count of Adult	BoCC:Amber; WYBAP	1,671
SE0842	Kestrel	<i>Falco tinnunculus</i>	bird	1970 - 1988	field record		BoCC:Amber; WYBAP	1,472
SE058438	Pied Flycatcher	<i>Ficedula hypoleuca</i>	bird	2008	field record		BoCC:Amber	1,896
SE0519843259	Oystercatcher	<i>Haematopus ostralegus</i>	bird	21/06/2013	field record	1 Count	BoCC:Amber	1,795
SE0536843327	Oystercatcher	<i>Haematopus ostralegus</i>	bird	21/06/2013	field record	1 Count	BoCC:Amber	1,724
SE0643142885	Oystercatcher	<i>Haematopus ostralegus</i>	bird	20/06/2013	field record	2 Count	BoCC:Amber	844
SE0657742629	Oystercatcher	<i>Haematopus ostralegus</i>	bird	29/04/2013	field record	2 Count	BoCC:Amber	585
SE0542	Swallow	<i>Hirundo rustica</i>	bird	1970 - 1988	field record		BoCC:Amber; WYBAP	1,521
SE058438	Swallow	<i>Hirundo rustica</i>	bird	1970 - 1988	field record		BoCC:Amber; WYBAP	1,896
SE0642	Swallow	<i>Hirundo rustica</i>	bird	1970 - 1988	field record		BoCC:Amber; WYBAP	526
SE0743	Swallow	<i>Hirundo rustica</i>	bird	1970 - 1988	field record		BoCC:Amber; WYBAP	1,065
SE0842	Swallow	<i>Hirundo rustica</i>	bird	1970 - 1988	field record		BoCC:Amber; WYBAP	1,472

Grid Ref	Common Name	Latin Name	Taxon Group	Date	Record Type	Abundance	Designation	Distance from site centroid (m)
SE0843	Swallow	<i>Hirundo rustica</i>	bird	1970 - 1988	field record		BoCC:Amber; WYBAP	1,753
SE0843	Red Grouse	<i>Lagopus lagopus</i>	bird	1970 - 1988	field record		BoCC:Amber; UKBAP; WYBAP	1,753
SE058438	Herring Gull	<i>Larus argentatus</i>	bird	1970 - 1988	field record		BoCC:Red; UKBAP	1,896
SE058438	Common Gull	<i>Larus canus</i>	bird	1970 - 1988	field record		BoCC:Amber	1,896
SE0841	Common Gull	<i>Larus canus</i>	bird	1970 - 1988	field record		BoCC:Amber	1,805
SE058438	Lesser Black-Backed Gull	<i>Larus fuscus</i>	bird	1970 - 1988	field record		BoCC:Amber	1,896
SE0842	Lesser Black-Backed Gull	<i>Larus fuscus</i>	bird	1970 - 1988	field record		BoCC:Amber	1,472
SE0843	Lesser Black-Backed Gull	<i>Larus fuscus</i>	bird	1970 - 1988	field record		BoCC:Amber	1,753
SE058438	Great Black-Backed Gull	<i>Larus marinus</i>	bird	1970 - 1988	field record		BoCC:Amber	1,896
SE058438	Black-Headed Gull	<i>Larus ridibundus</i>	bird	1970 - 1988	field record		BoCC:Amber	1,896
SE0741	Black-Headed Gull	<i>Larus ridibundus</i>	bird	1970 - 1988	field record		BoCC:Amber	1,148
SE0842	Black-Headed Gull	<i>Larus ridibundus</i>	bird	1970 - 1988	field record		BoCC:Amber	1,472
SE0643	Grasshopper Warbler	<i>Locustella naevia</i>	bird	1970 - 1988	field record		BoCC:Red; UKBAP; WYBAP	1,088
SE071423	Grasshopper Warbler	<i>Locustella naevia</i>	bird	23/04/2008 - 13/05/2008	field record		BoCC:Red; UKBAP; WYBAP	627

Grid Ref	Common Name	Latin Name	Taxon Group	Date	Record Type	Abundance	Designation	Distance from site centroid (m)
SE0841	Grasshopper Warbler	<i>Locustella naevia</i>	bird	1970 - 1988	field record		BoCC:Red; UKBAP; WYBAP	1,805
SE0510740907	Grey Wagtail	<i>Motacilla cinerea</i>	bird	19/03/2010	field record		BoCC:Amber	1,815
SE0547743341	Grey Wagtail	<i>Motacilla cinerea</i>	bird	21/06/2013	field record	2 Count	BoCC:Amber	1,664
SE0583943295	Grey Wagtail	<i>Motacilla cinerea</i>	bird	20/06/2013	field record	2 Count of Juvenile	BoCC:Amber	1,424
SE058438	Grey Wagtail	<i>Motacilla cinerea</i>	bird	1970 - 1988	field record		BoCC:Amber	1,896
SE0842	Grey Wagtail	<i>Motacilla cinerea</i>	bird	1970 - 1988	field record		BoCC:Amber	1,472
SE058438	Yellow Wagtail	<i>Motacilla flava subsp. flavissima</i>	bird	1970 - 1988	field record		BoCC:Red; UKBAP; WYBAP	1,896
SE0542	Spotted Flycatcher	<i>Muscicapa striata</i>	bird	1970 - 1988	field record		BoCC:Red; UKBAP; WYBAP	1,521
SE058438	Spotted Flycatcher	<i>Muscicapa striata</i>	bird	2008	field record		BoCC:Red; UKBAP; WYBAP	1,896
SE058438	Spotted Flycatcher	<i>Muscicapa striata</i>	bird	1970 - 1988	field record		BoCC:Red; UKBAP; WYBAP	1,896
SE0643	Spotted Flycatcher	<i>Muscicapa striata</i>	bird	1970 - 1988	field record		BoCC:Red; UKBAP; WYBAP	1,088
SE071423	Spotted Flycatcher	<i>Muscicapa striata</i>	bird	2008	field record		BoCC:Red; UKBAP; WYBAP	627
SE0841	Spotted Flycatcher	<i>Muscicapa striata</i>	bird	1970 - 1988	field record		BoCC:Red; UKBAP; WYBAP	1,805

Grid Ref	Common Name	Latin Name	Taxon Group	Date	Record Type	Abundance	Designation	Distance from site centroid (m)
SE0842	Spotted Flycatcher	<i>Muscicapa striata</i>	bird	1970 - 1988	field record		BoCC:Red; UKBAP; WYBAP	1,472
SE058438	Curlew	<i>Numenius arquata</i>	bird	1970 - 1988	field record		BoCC:Amber; UKBAP; WYBAP	1,896
SE0595943139	Curlew	<i>Numenius arquata</i>	bird	20/06/2013	field record	1 Count	BoCC:Amber; UKBAP; WYBAP	1,230
SE0660543764	Curlew	<i>Numenius arquata</i>	bird	12/06/2013	field record	1 Count	BoCC:Amber; UKBAP; WYBAP	1,719
SE0666243751	Curlew	<i>Numenius arquata</i>	bird	12/06/2013	field record	1 Count	BoCC:Amber; UKBAP; WYBAP	1,710
SE0672543822	Curlew	<i>Numenius arquata</i>	bird	14/06/2013	field record	2 Count	BoCC:Amber; UKBAP; WYBAP	1,786
SE0696543808	Curlew	<i>Numenius arquata</i>	bird	23/04/2013	field record	2 Count	BoCC:Amber; UKBAP; WYBAP	1,815
SE0702443557	Curlew	<i>Numenius arquata</i>	bird	14/06/2013	field record	1 Count	BoCC:Amber; UKBAP; WYBAP	1,590
SE0709543814	Curlew	<i>Numenius arquata</i>	bird	23/04/2013	field record	1 Count	BoCC:Amber; UKBAP; WYBAP	1,856
SE0713443472	Curlew	<i>Numenius arquata</i>	bird	14/06/2013	field record	1 Count	BoCC:Amber; UKBAP; WYBAP	1,549

Grid Ref	Common Name	Latin Name	Taxon Group	Date	Record Type	Abundance	Designation	Distance from site centroid (m)
SE0721343811	Curlew	<i>Numenius arquata</i>	bird	08/05/2013	field record	1 Count	BoCC:Amber; UKBAP; WYBAP	1,893
SE0724143774	Curlew	<i>Numenius arquata</i>	bird	23/04/2013	field record	1 Count	BoCC:Amber; UKBAP; WYBAP	1,869
SE0737743725	Curlew	<i>Numenius arquata</i>	bird	23/04/2013	field record	1 Count	BoCC:Amber; UKBAP; WYBAP	1,881
SE0745343389	Curlew	<i>Numenius arquata</i>	bird	14/06/2013	field record	2 Count	BoCC:Amber; UKBAP; WYBAP	1,630
SE0746543758	Curlew	<i>Numenius arquata</i>	bird	05/07/2013	field record	1 Count	BoCC:Amber; UKBAP; WYBAP	1,951
SE0750743329	Curlew	<i>Numenius arquata</i>	bird	14/06/2013	field record	2 Count	BoCC:Amber; UKBAP; WYBAP	1,614
SE0755143537	Curlew	<i>Numenius arquata</i>	bird	08/05/2013	field record	1 Count	BoCC:Amber; UKBAP; WYBAP	1,808
SE0755543371	Curlew	<i>Numenius arquata</i>	bird	23/04/2013	field record	1 Count	BoCC:Amber; UKBAP; WYBAP	1,676
SE0763943667	Curlew	<i>Numenius arquata</i>	bird	05/07/2013	field record	1 Count	BoCC:Amber; UKBAP; WYBAP	1,964
SE0766543238	Curlew	<i>Numenius arquata</i>	bird	23/04/2013	field record	1 Count	BoCC:Amber; UKBAP; WYBAP	1,647

Grid Ref	Common Name	Latin Name	Taxon Group	Date	Record Type	Abundance	Designation	Distance from site centroid (m)
SE0777243314	Curlew	<i>Numenius arquata</i>	bird	23/04/2013	field record	1 Count	BoCC:Amber; UKBAP; WYBAP	1,776
SE0793443361	Curlew	<i>Numenius arquata</i>	bird	08/05/2013	field record	1 Count	BoCC:Amber; UKBAP; WYBAP	1,924
SE0808043286	Curlew	<i>Numenius arquata</i>	bird	23/04/2013	field record	1 Count	BoCC:Amber; UKBAP; WYBAP	1,985
SE0834142885	Curlew	<i>Numenius arquata</i>	bird	12/06/2013	field record	1 Count	BoCC:Amber; UKBAP; WYBAP	1,996
SE0841	Curlew	<i>Numenius arquata</i>	bird	1970 - 1988	field record		BoCC:Amber; UKBAP; WYBAP	1,805
SE0843	Curlew	<i>Numenius arquata</i>	bird	1970 - 1988	field record		BoCC:Amber; UKBAP; WYBAP	1,753
SE0847742764	Curlew	<i>Numenius arquata</i>	bird	12/06/2013	field record	1 Count	BoCC:Amber; UKBAP; WYBAP	2,075
SE058438	Wheatear	<i>Oenanthe oenanthe</i>	bird	1970 - 1988	field record		BoCC:Amber	1,896
SE0643	Wheatear	<i>Oenanthe oenanthe</i>	bird	1970 - 1988	field record		BoCC:Amber	1,088
SE0542	Marsh Tit	<i>Parus palustris</i>	bird	1970 - 1988	field record		BoCC:Red; UKBAP	1,521
SE0510740907	House Sparrow	<i>Passer domesticus</i>	bird	19/03/2010	field record	4 Count	BoCC:Red; UKBAP; WYBAP	1,815

Grid Ref	Common Name	Latin Name	Taxon Group	Date	Record Type	Abundance	Designation	Distance from site centroid (m)
SE0532043089	House Sparrow	<i>Passer domesticus</i>	bird	21/06/2013	field record	2 Count	BoCC:Red; UKBAP; WYBAP	1,591
SE0534543110	House Sparrow	<i>Passer domesticus</i>	bird	29/04/2013	field record	1 Count	BoCC:Red; UKBAP; WYBAP	1,586
SE0542	House Sparrow	<i>Passer domesticus</i>	bird	1970 - 1988	field record		BoCC:Red; UKBAP; WYBAP	1,521
SE0568443483	House Sparrow	<i>Passer domesticus</i>	bird	21/06/2013	field record	2 Count	BoCC:Red; UKBAP; WYBAP	1,663
SE058438	House Sparrow	<i>Passer domesticus</i>	bird	1970 - 1988	field record		BoCC:Red; UKBAP; WYBAP	1,896
SE0642	House Sparrow	<i>Passer domesticus</i>	bird	1970 - 1988	field record		BoCC:Red; UKBAP; WYBAP	526
SE0643	House Sparrow	<i>Passer domesticus</i>	bird	1970 - 1988	field record		BoCC:Red; UKBAP; WYBAP	1,088
SE0660842899	House Sparrow	<i>Passer domesticus</i>	bird	20/06/2013	field record	2 Count	BoCC:Red; UKBAP; WYBAP	857
SE0667343243	House Sparrow	<i>Passer domesticus</i>	bird	12/06/2013	field record	1 Count	BoCC:Red; UKBAP; WYBAP	1,206
SE0674343569	House Sparrow	<i>Passer domesticus</i>	bird	12/06/2013	field record	1 Count	BoCC:Red; UKBAP; WYBAP	1,538

Grid Ref	Common Name	Latin Name	Taxon Group	Date	Record Type	Abundance	Designation	Distance from site centroid (m)
SE0676743423	House Sparrow	<i>Passer domesticus</i>	bird	24/04/2013	field record	2 Count	BoCC:Red; UKBAP; WYBAP	1,397
SE0681643459	House Sparrow	<i>Passer domesticus</i>	bird	12/06/2013	field record	2 Count	BoCC:Red; UKBAP; WYBAP	1,442
SE0696342757	House Sparrow	<i>Passer domesticus</i>	bird	20/06/2013	field record	4 Count	BoCC:Red; UKBAP; WYBAP	834
SE0715843185	House Sparrow	<i>Passer domesticus</i>	bird	14/06/2013	field record	2 Count	BoCC:Red; UKBAP; WYBAP	1,302
SE0723642939	House Sparrow	<i>Passer domesticus</i>	bird	23/04/2013	field record	1 Count	BoCC:Red; UKBAP; WYBAP	1,140
SE0724842599	House Sparrow	<i>Passer domesticus</i>	bird	20/06/2013	field record	4 Count	BoCC:Red; UKBAP; WYBAP	908
SE0775642916	House Sparrow	<i>Passer domesticus</i>	bird	14/06/2013	field record	2 Count	BoCC:Red; UKBAP; WYBAP	1,504
SE0779143175	House Sparrow	<i>Passer domesticus</i>	bird	14/06/2013	field record	2 Count	BoCC:Red; UKBAP; WYBAP	1,693
SE0779143206	House Sparrow	<i>Passer domesticus</i>	bird	14/06/2013	field record	4 Count	BoCC:Red; UKBAP; WYBAP	1,714
SE0797542848	House Sparrow	<i>Passer domesticus</i>	bird	23/04/2013	field record	1 Count	BoCC:Red; UKBAP; WYBAP	1,653

Grid Ref	Common Name	Latin Name	Taxon Group	Date	Record Type	Abundance	Designation	Distance from site centroid (m)
SE0807942947	House Sparrow	<i>Passer domesticus</i>	bird	12/06/2013	field record	2 Count	BoCC:Red; UKBAP; WYBAP	1,792
SE0842	House Sparrow	<i>Passer domesticus</i>	bird	1970 - 1988	field record		BoCC:Red; UKBAP; WYBAP	1,472
SE0843	House Sparrow	<i>Passer domesticus</i>	bird	1970 - 1988	field record		BoCC:Red; UKBAP; WYBAP	1,753
SE058438	Tree Sparrow	<i>Passer montanus</i>	bird	1970 - 1988	field record		BoCC:Red; UKBAP; WYBAP	1,896
SE071423	Tree Sparrow	<i>Passer montanus</i>	bird	01/10/2008	field record	2 Range of Adult	BoCC:Red; UKBAP; WYBAP	627
SE0842	Tree Sparrow	<i>Passer montanus</i>	bird	1970 - 1988	field record		BoCC:Red; UKBAP; WYBAP	1,472
SE058438	Grey Partridge	<i>Perdix perdix</i>	bird	1970 - 1988	field record		BoCC:Red; UKBAP; WYBAP	1,896
SE0842	Grey Partridge	<i>Perdix perdix</i>	bird	1970 - 1988	field record		BoCC:Red; UKBAP; WYBAP	1,472
SE058438	Redstart	<i>Phoenicurus phoenicurus</i>	bird	1970 - 1988	field record		BoCC:Amber	1,896
SE0643	Redstart	<i>Phoenicurus phoenicurus</i>	bird	1970 - 1988	field record		BoCC:Amber	1,088
SE058438	Wood Warbler	<i>Phylloscopus sibilatrix</i>	bird	1970 - 1988	field record		BoCC:Red; UKBAP; WYBAP	1,896

Grid Ref	Common Name	Latin Name	Taxon Group	Date	Record Type	Abundance	Designation	Distance from site centroid (m)
SE084421	Wood Warbler	<i>Phylloscopus sibilatrix</i>	bird	06/06/2011	field observation		BoCC:Red; UKBAP; WYBAP	1,871
SE0542	Willow Warbler	<i>Phylloscopus trochilus</i>	bird	1970 - 1988	field record		BoCC:Amber	1,521
SE058438	Willow Warbler	<i>Phylloscopus trochilus</i>	bird	1970 - 1988	field record		BoCC:Amber	1,896
SE0741	Willow Warbler	<i>Phylloscopus trochilus</i>	bird	1970 - 1988	field record		BoCC:Amber	1,148
SE0842	Willow Warbler	<i>Phylloscopus trochilus</i>	bird	1970 - 1988	field record		BoCC:Amber	1,472
SE0843	Willow Warbler	<i>Phylloscopus trochilus</i>	bird	1970 - 1988	field record		BoCC:Amber	1,753
SE058421	Green Woodpecker	<i>Picus viridis</i>	bird	19/06/2010	field record	2 Count of Adult	BoCC:Amber	725
SE058438	Green Woodpecker	<i>Picus viridis</i>	bird	1970 - 1988	field record		BoCC:Amber	1,896
SE0637943532	Green Woodpecker	<i>Picus viridis</i>	bird	12/06/2013	field record	3 Count	BoCC:Amber	1,492
SE0643	Green Woodpecker	<i>Picus viridis</i>	bird	1970 - 1988	field record		BoCC:Amber	1,088
SE0842	Green Woodpecker	<i>Picus viridis</i>	bird	1970 - 1988	field record		BoCC:Amber	1,472
SE0658643935	Golden Plover	<i>Pluvialis apricaria</i>	bird	24/04/2013	field record	4 Count	BoCC:Amber; WYBAP	1,889
SE0510740907	Dunnock	<i>Prunella modularis</i>	bird	19/03/2010	auditory record	8 Count	BoCC:Amber; UKBAP; WYBAP	1,815
SE0542	Dunnock	<i>Prunella modularis</i>	bird	1970 - 1988	field record		BoCC:Amber; UKBAP; WYBAP	1,521

Grid Ref	Common Name	Latin Name	Taxon Group	Date	Record Type	Abundance	Designation	Distance from site centroid (m)
SE058421	Dunnock	<i>Prunella modularis</i>	bird	19/06/2010	field record	1 Count of Adult	BoCC:Amber; UKBAP; WYBAP	725
SE058421	Hedge Accentor	<i>Prunella modularis</i>	bird	19/06/2015	None		BoCC:Amber; UKBAP; WYBAP	725
SE058438	Dunnock	<i>Prunella modularis</i>	bird	1970 - 1988	field record		BoCC:Amber; UKBAP; WYBAP	1,896
SE0642	Dunnock	<i>Prunella modularis</i>	bird	1970 - 1988	field record		BoCC:Amber; UKBAP; WYBAP	526
SE0643	Dunnock	<i>Prunella modularis</i>	bird	1970 - 1988	field record		BoCC:Amber; UKBAP; WYBAP	1,088
SE0841	Dunnock	<i>Prunella modularis</i>	bird	1970 - 1988	field record		BoCC:Amber; UKBAP; WYBAP	1,805
SE0842	Dunnock	<i>Prunella modularis</i>	bird	1970 - 1988	field record		BoCC:Amber; UKBAP; WYBAP	1,472
SE084421	Dunnock	<i>Prunella modularis</i>	bird	06/06/2011	field observation		BoCC:Amber; UKBAP; WYBAP	1,871
SE0510740907	Bullfinch	<i>Pyrrhula pyrrhula</i>	bird	19/03/2010	auditory record	1 Count	BoCC:Amber; UKBAP; WYBAP	1,815
SE0542	Bullfinch	<i>Pyrrhula pyrrhula</i>	bird	1970 - 1988	field record		BoCC:Amber; UKBAP; WYBAP	1,521

Grid Ref	Common Name	Latin Name	Taxon Group	Date	Record Type	Abundance	Designation	Distance from site centroid (m)
SE058438	Bullfinch	<i>Pyrrhula pyrrhula</i>	bird	1970 - 1988	field record		BoCC:Amber; UKBAP; WYBAP	1,896
SE0643	Bullfinch	<i>Pyrrhula pyrrhula</i>	bird	1970 - 1988	field record		BoCC:Amber; UKBAP; WYBAP	1,088
SE065431	Common Bullfinch	<i>Pyrrhula pyrrhula</i>	bird	10/06/2011	field observation		BoCC:Amber; UKBAP; WYBAP	1,054
SE0841	Bullfinch	<i>Pyrrhula pyrrhula</i>	bird	1970 - 1988	field record		BoCC:Amber; UKBAP; WYBAP	1,805
SE0842	Bullfinch	<i>Pyrrhula pyrrhula</i>	bird	1970 - 1988	field record		BoCC:Amber; UKBAP; WYBAP	1,472
SE072426	Firecrest	<i>Regulus ignicapillus</i>	bird	16/11/2008	field record	1 Range of Adult	BoCC:Amber	872
SE058438	Sand Martin	<i>Riparia riparia</i>	bird	1970 - 1988	field record		BoCC:Amber	1,896
SE0596943288	Sand Martin	<i>Riparia riparia</i>	bird	20/06/2013	field record	5 Count	BoCC:Amber	1,360
SE0610943163	Sand Martin	<i>Riparia riparia</i>	bird	29/04/2013	field record	8 Count	BoCC:Amber	1,191
SE0632042842	Sand Martin	<i>Riparia riparia</i>	bird	20/06/2013	field record	10 Count	BoCC:Amber	821
SE0642	Sand Martin	<i>Riparia riparia</i>	bird	1970 - 1988	field record		BoCC:Amber	526
SE058438	Woodcock	<i>Scolopax rusticola</i>	bird	1970 - 1988	field record		BoCC:Amber	1,896
SE0510740907	Starling	<i>Sturnus vulgaris</i>	bird	19/03/2010	auditory record		BoCC:Red; UKBAP; WYBAP	1,815

Grid Ref	Common Name	Latin Name	Taxon Group	Date	Record Type	Abundance	Designation	Distance from site centroid (m)
SE0525143416	Starling	<i>Sturnus vulgaris</i>	bird	21/06/2013	field record	57 Count	BoCC:Red; UKBAP; WYBAP	1,868
SE0531643058	Starling	<i>Sturnus vulgaris</i>	bird	29/04/2013	field record	1 Count	BoCC:Red; UKBAP; WYBAP	1,574
SE0536243020	Starling	<i>Sturnus vulgaris</i>	bird	21/06/2013	field record	9 Count	BoCC:Red; UKBAP; WYBAP	1,514
SE0542	Starling	<i>Sturnus vulgaris</i>	bird	1970 - 1988	field record		BoCC:Red; UKBAP; WYBAP	1,521
SE0542843358	Starling	<i>Sturnus vulgaris</i>	bird	29/04/2013	field record	1 Count	BoCC:Red; UKBAP; WYBAP	1,708
SE0549343069	Starling	<i>Sturnus vulgaris</i>	bird	21/06/2013	field record	5 Count	BoCC:Red; UKBAP; WYBAP	1,451
SE0578543526	Starling	<i>Sturnus vulgaris</i>	bird	21/06/2013	field record	6 Count	BoCC:Red; UKBAP; WYBAP	1,653
SE058438	Starling	<i>Sturnus vulgaris</i>	bird	1970 - 1988	field record		BoCC:Red; UKBAP; WYBAP	1,896
SE0592143754	Starling	<i>Sturnus vulgaris</i>	bird	20/06/2013	field record	8 Count	BoCC:Red; UKBAP; WYBAP	1,810
SE0642	Starling	<i>Sturnus vulgaris</i>	bird	1970 - 1988	field record		BoCC:Red; UKBAP; WYBAP	526

Grid Ref	Common Name	Latin Name	Taxon Group	Date	Record Type	Abundance	Designation	Distance from site centroid (m)
SE0643	Starling	<i>Sturnus vulgaris</i>	bird	1970 - 1988	field record		BoCC:Red; UKBAP; WYBAP	1,088
SE0661143080	Starling	<i>Sturnus vulgaris</i>	bird	29/04/2013	field record	2 Count	BoCC:Red; UKBAP; WYBAP	1,037
SE0666843640	Starling	<i>Sturnus vulgaris</i>	bird	24/04/2013	field record	2 Count	BoCC:Red; UKBAP; WYBAP	1,600
SE0670343175	Starling	<i>Sturnus vulgaris</i>	bird	24/04/2013	field record	1 Count	BoCC:Red; UKBAP; WYBAP	1,142
SE0675343605	Starling	<i>Sturnus vulgaris</i>	bird	24/04/2013	field record	1 Count	BoCC:Red; UKBAP; WYBAP	1,575
SE0675543068	Starling	<i>Sturnus vulgaris</i>	bird	12/06/2013	field record	9 Count	BoCC:Red; UKBAP; WYBAP	1,047
SE0678643416	Starling	<i>Sturnus vulgaris</i>	bird	12/06/2013	field record	8 Count	BoCC:Red; UKBAP; WYBAP	1,394
SE0685943360	Starling	<i>Sturnus vulgaris</i>	bird	24/04/2013	field record	2 Count	BoCC:Red; UKBAP; WYBAP	1,355
SE0690842808	Starling	<i>Sturnus vulgaris</i>	bird	20/06/2013	field record	4 Count	BoCC:Red; UKBAP; WYBAP	852
SE0695543254	Starling	<i>Sturnus vulgaris</i>	bird	12/06/2013	field record	8 Count	BoCC:Red; UKBAP; WYBAP	1,281

Grid Ref	Common Name	Latin Name	Taxon Group	Date	Record Type	Abundance	Designation	Distance from site centroid (m)
SE0697742684	Starling	<i>Sturnus vulgaris</i>	bird	29/04/2013	field record	2 Count	BoCC:Red; UKBAP; WYBAP	781
SE0714743028	Starling	<i>Sturnus vulgaris</i>	bird	14/06/2013	field record	21 Count	BoCC:Red; UKBAP; WYBAP	1,161
SE0717443077	Starling	<i>Sturnus vulgaris</i>	bird	23/04/2013	field record	3 Count	BoCC:Red; UKBAP; WYBAP	1,217
SE0719742632	Starling	<i>Sturnus vulgaris</i>	bird	20/06/2013	field record	2 Count	BoCC:Red; UKBAP; WYBAP	890
SE0720743382	Starling	<i>Sturnus vulgaris</i>	bird	14/06/2013	field record	1 Count	BoCC:Red; UKBAP; WYBAP	1,499
SE0721542951	Starling	<i>Sturnus vulgaris</i>	bird	14/06/2013	field record	2 Count	BoCC:Red; UKBAP; WYBAP	1,137
SE0725843490	Starling	<i>Sturnus vulgaris</i>	bird	14/06/2013	field record	1 Count	BoCC:Red; UKBAP; WYBAP	1,618
SE0730143379	Starling	<i>Sturnus vulgaris</i>	bird	23/04/2013	field record	1 Count	BoCC:Red; UKBAP; WYBAP	1,541
SE0758942787	Starling	<i>Sturnus vulgaris</i>	bird	23/04/2013	field record	2 Count	BoCC:Red; UKBAP; WYBAP	1,294
SE0765542788	Starling	<i>Sturnus vulgaris</i>	bird	14/06/2013	field record	5 Count	BoCC:Red; UKBAP; WYBAP	1,349

Grid Ref	Common Name	Latin Name	Taxon Group	Date	Record Type	Abundance	Designation	Distance from site centroid (m)
SE0771242858	Starling	<i>Sturnus vulgaris</i>	bird	14/06/2013	field record	3 Count	BoCC:Red; UKBAP; WYBAP	1,435
SE0775443081	Starling	<i>Sturnus vulgaris</i>	bird	14/06/2013	field record	31 Count	BoCC:Red; UKBAP; WYBAP	1,604
SE0808743034	Starling	<i>Sturnus vulgaris</i>	bird	23/04/2013	field record	2 Count	BoCC:Red; UKBAP; WYBAP	1,844
SE0842	Starling	<i>Sturnus vulgaris</i>	bird	1970 - 1988	field record		BoCC:Red; UKBAP; WYBAP	1,472
SE0843	Starling	<i>Sturnus vulgaris</i>	bird	1970 - 1988	field record		BoCC:Red; UKBAP; WYBAP	1,753
SE0862542315	Starling	<i>Sturnus vulgaris</i>	bird	11/06/2013	field record	21 Count	BoCC:Red; UKBAP; WYBAP	2,111
SE058438	Whitethroat	<i>Sylvia communis</i>	bird	1970 - 1988	field record		BoCC:Amber	1,896
SE071423	Whitethroat	<i>Sylvia communis</i>	bird	2008	field record		BoCC:Amber	627
SE0741	Whitethroat	<i>Sylvia communis</i>	bird	1970 - 1988	field record		BoCC:Amber	1,148
SE0841	Shelduck	<i>Tadorna tadorna</i>	bird	1970 - 1988	field record		BoCC:Amber	1,805
SE0742	Redshank	<i>Tringa totanus</i>	bird	1970 - 1988	field record		BoCC:Amber	476
SE0842	Redshank	<i>Tringa totanus</i>	bird	1970 - 1988	field record		BoCC:Amber	1,472
SE058438	Redwing	<i>Turdus iliacus</i>	bird	1970 - 1988	field record		Sch1_part1; BoCC:Red	1,896

Grid Ref	Common Name	Latin Name	Taxon Group	Date	Record Type	Abundance	Designation	Distance from site centroid (m)
SE0643	Redwing	<i>Turdus iliacus</i>	bird	1970 - 1988	field record		Sch1_part1; BoCC:Red	1,088
SE0842	Redwing	<i>Turdus iliacus</i>	bird	1970 - 1988	field record		Sch1_part1; BoCC:Red	1,472
SE0510740907	Song Thrush	<i>Turdus philomelos</i>	bird	19/03/2010	auditory record		BoCC:Red; UKBAP; WYBAP	1,815
SE0542	Song Thrush	<i>Turdus philomelos</i>	bird	1970 - 1988	field record		BoCC:Red; UKBAP; WYBAP	1,521
SE057438	Song Thrush	<i>Turdus philomelos</i>	bird	04/07/2012	field observation		BoCC:Red; UKBAP; WYBAP	1,937
SE058421	Song Thrush	<i>Turdus philomelos</i>	bird	19/06/2010	field record	3 Count of Adult	BoCC:Red; UKBAP; WYBAP	725
SE058438	Song Thrush	<i>Turdus philomelos</i>	bird	1970 - 1988	field record		BoCC:Red; UKBAP; WYBAP	1,896
SE0642	Song Thrush	<i>Turdus philomelos</i>	bird	1970 - 1988	field record		BoCC:Red; UKBAP; WYBAP	526
SE0643	Song Thrush	<i>Turdus philomelos</i>	bird	1970 - 1988	field record		BoCC:Red; UKBAP; WYBAP	1,088
SE065431	Song Thrush	<i>Turdus philomelos</i>	bird	10/06/2011	field observation		BoCC:Red; UKBAP; WYBAP	1,054
SE069409	Song Thrush	<i>Turdus philomelos</i>	bird	03/06/2011	field observation		BoCC:Red; UKBAP; WYBAP	1,205

Grid Ref	Common Name	Latin Name	Taxon Group	Date	Record Type	Abundance	Designation	Distance from site centroid (m)
SE0841	Song Thrush	<i>Turdus philomelos</i>	bird	1970 - 1988	field record		BoCC:Red; UKBAP; WYBAP	1,805
SE0842	Song Thrush	<i>Turdus philomelos</i>	bird	1970 - 1988	field record		BoCC:Red; UKBAP; WYBAP	1,472
SE084421	Song Thrush	<i>Turdus philomelos</i>	bird	06/06/2011	field observation		BoCC:Red; UKBAP; WYBAP	1,871
SE0542	Fieldfare	<i>Turdus pilaris</i>	bird	1970 - 1988	field record		Sch1_part1; BoCC:Red	1,521
SE058438	Fieldfare	<i>Turdus pilaris</i>	bird	1970 - 1988	field record		Sch1_part1; BoCC:Red	1,896
SE0842	Fieldfare	<i>Turdus pilaris</i>	bird	1970 - 1988	field record		Sch1_part1; BoCC:Red	1,472
SE0510740907	Mistle Thrush	<i>Turdus viscivorus</i>	bird	19/03/2010	field record	3 Count	BoCC:Amber	1,815
SE0542	Mistle Thrush	<i>Turdus viscivorus</i>	bird	1970 - 1988	field record		BoCC:Amber	1,521
SE058438	Mistle Thrush	<i>Turdus viscivorus</i>	bird	1970 - 1988	field record		BoCC:Amber	1,896
SE0641	Mistle Thrush	<i>Turdus viscivorus</i>	bird	1970 - 1988	field record		BoCC:Amber	1,169
SE0643	Mistle Thrush	<i>Turdus viscivorus</i>	bird	1970 - 1988	field record		BoCC:Amber	1,088
SE0842	Mistle Thrush	<i>Turdus viscivorus</i>	bird	1970 - 1988	field record		BoCC:Amber	1,472
SE0642	Lapwing	<i>Vanellus vanellus</i>	bird	1970 - 1988	field record		BoCC:Red; UKBAP; WYBAP; Bradford BAP	526
SE0723143749	Lapwing	<i>Vanellus vanellus</i>	bird	05/07/2013	field record	1 Count	BoCC:Red; UKBAP;	1,842

Grid Ref	Common Name	Latin Name	Taxon Group	Date	Record Type	Abundance	Designation	Distance from site centroid (m)
							WYBAP; Bradford BAP	
SE0727843781	Lapwing	<i>Vanellus vanellus</i>	bird	08/05/2013	field record	1 Count	BoCC:Red; UKBAP; WYBAP; Bradford BAP	1,890
SE0741443730	Lapwing	<i>Vanellus vanellus</i>	bird	08/05/2013	field record	1 Count	BoCC:Red; UKBAP; WYBAP; Bradford BAP	1,902
SE0743	Lapwing	<i>Vanellus vanellus</i>	bird	1970 - 1988	field record		BoCC:Red; UKBAP; WYBAP; Bradford BAP	1,065
SE0754643734	Lapwing	<i>Vanellus vanellus</i>	bird	08/05/2013	field record	1 Count	BoCC:Red; UKBAP; WYBAP; Bradford BAP	1,971
SE0758243699	Lapwing	<i>Vanellus vanellus</i>	bird	08/05/2013	field record	1 Count	BoCC:Red; UKBAP; WYBAP; Bradford BAP	1,960
SE0768543619	Lapwing	<i>Vanellus vanellus</i>	bird	23/04/2013	field record	1 Count	BoCC:Red; UKBAP; WYBAP; Bradford BAP	1,952
SE0771343596	Lapwing	<i>Vanellus vanellus</i>	bird	08/05/2013	field record	1 Count	BoCC:Red; UKBAP; WYBAP; Bradford BAP	1,950
SE0774043614	Lapwing	<i>Vanellus vanellus</i>	bird	08/05/2013	field record	1 Count	BoCC:Red; UKBAP;	1,981

Grid Ref	Common Name	Latin Name	Taxon Group	Date	Record Type	Abundance	Designation	Distance from site centroid (m)
							WYBAP; Bradford BAP	
SE0785343577	Lapwing	<i>Vanellus vanellus</i>	bird	12/06/2013	field record	1 Count	BoCC:Red; UKBAP; WYBAP; Bradford BAP	2,024
SE0802243234	Lapwing	<i>Vanellus vanellus</i>	bird	23/04/2013	field record	1 Count	BoCC:Red; UKBAP; WYBAP; Bradford BAP	1,907
SE0842	Lapwing	<i>Vanellus vanellus</i>	bird	1970 - 1988	field record		BoCC:Red; UKBAP; WYBAP; Bradford BAP	1,472
SE0843	Lapwing	<i>Vanellus vanellus</i>	bird	1970 - 1988	field record		BoCC:Red; UKBAP; WYBAP; Bradford BAP	1,753
SE0645040980	European Eel	<i>Anguilla anguilla</i>	bony fish (Actinoptery gii)	25/04/2006	field record		UKBAP; WYBAP	1,068
SE07084094	Wall Cotoneaster	<i>Cotoneaster horizontalis</i>	flowering plant	03/06/2011	field observation	R Count of DAFOR	Sch9_part2	1,236
SE07104245	Wall Cotoneaster	<i>Cotoneaster horizontalis</i>	flowering plant	11/09/2012	field observation	R Count of DAFOR	Sch9_part2	701
SE07094241	New Zealand Pigmyweed	<i>Crassula helmsii</i>	flowering plant	11/09/2012	field observation	LA Count of DAFOR	Sch9_part2	671
SE0742	Montbretia	<i>Crocsmia x crocsmiiflora</i>	flowering plant	10/08/1983	field record		Sch9_part2	476
SE0542	Canadian Waterweed	<i>Elodea canadensis</i>	flowering plant	26/06/1983	field record		Sch9_part2	1,521

Grid Ref	Common Name	Latin Name	Taxon Group	Date	Record Type	Abundance	Designation	Distance from site centroid (m)
SE061426	Canadian Waterweed	<i>Elodea canadensis</i>	flowering plant	16/09/2002	field record	D Range of DAFOR	Sch9_part2	697
SE061426	Canadian Waterweed	<i>Elodea canadensis</i>	flowering plant	1977	field record		Sch9_part2	697
SE061426	Canadian Waterweed	<i>Elodea canadensis</i>	flowering plant	21/06/1996	field record	A Range of DAFOR	Sch9_part2	697
SE060426	Japanese Knotweed	<i>Fallopia japonica</i>	flowering plant	Unknown	field record		Sch9_part2	762
SE061426	Japanese Knotweed	<i>Fallopia japonica</i>	flowering plant	16/09/2002	field record	O Range of DAFOR	Sch9_part2	697
SE0643	Japanese Knotweed	<i>Fallopia japonica</i>	flowering plant	29/06/1983	field record		Sch9_part2	1,088
SE0741	Large-Flowered Hemp-Nettle	<i>Galeopsis speciosa</i>	flowering plant	03/08/1970	field record		RDB:post2001:V U	1,148
SE0551342368	Bluebell	<i>Hyacinthoides non-scripta</i>	flowering plant	19/06/2010	field record	O Count of DAFOR	Sch8_sect 13.2; Bradford BAP	1,059
SE05514237	Bluebell	<i>Hyacinthoides non-scripta</i>	flowering plant	19/06/2015	field record	LA Count of DAFOR	Sch8_sect 13.2; Bradford BAP	1,063
SE05814366	Bluebell	<i>Hyacinthoides non-scripta</i>	flowering plant	04/07/2012	field observation	O Count of DAFOR	Sch8_sect 13.2; Bradford BAP	1,764
SE058438	Bluebell	<i>Hyacinthoides non-scripta</i>	flowering plant	31/01/1978	field record		Sch8_sect 13.2; Bradford BAP	1,896
SE06344339	Bluebell	<i>Hyacinthoides non-scripta</i>	flowering plant	10/06/2011	field observation	LF Count of DAFOR	Sch8_sect 13.2; Bradford BAP	1,356
SE06394332	Bluebell	<i>Hyacinthoides non-scripta</i>	flowering plant	10/06/2011	field observation	O Count of DAFOR	Sch8_sect 13.2; Bradford BAP	1,281
SE06434365	Bluebell	<i>Hyacinthoides non-scripta</i>	flowering plant	10/06/2011	field observation	R Count of DAFOR	Sch8_sect 13.2; Bradford BAP	1,606
SE06504323	Bluebell	<i>Hyacinthoides non-scripta</i>	flowering plant	10/06/2011	field observation	LF Count of DAFOR	Sch8_sect 13.2; Bradford BAP	1,184
SE07084094	Bluebell	<i>Hyacinthoides non-scripta</i>	flowering plant	03/06/2011	field observation	O Count of DAFOR	Sch8_sect 13.2; Bradford BAP	1,236

Grid Ref	Common Name	Latin Name	Taxon Group	Date	Record Type	Abundance	Designation	Distance from site centroid (m)
SE08404215	Bluebell	<i>Hyacinthoides non-scripta</i>	flowering plant	06/06/2011	field observation	O Count of DAFOR	Sch8_sect 13.2; Bradford BAP	1,873
SE08524215	Bluebell	<i>Hyacinthoides non-scripta</i>	flowering plant	11/04/2012	field observation	F Count of DAFOR	Sch8_sect 13.2; Bradford BAP	1,992
SE061426	Frogbit	<i>Hydrocharis morsus-ranae</i>	flowering plant	21/06/1996	field record	O Range of DAFOR	RDB:post2001:V U	697
SE061426	Frogbit	<i>Hydrocharis morsus-ranae</i>	flowering plant	16/09/2002	field record	O Range of DAFOR	RDB:post2001:V U	697
SE061426	Frogbit	<i>Hydrocharis morsus-ranae</i>	flowering plant	1977	field record		RDB:post2001:V U	697
SE061426	Frogbit	<i>Hydrocharis morsus-ranae</i>	flowering plant	11/09/1986	field record		RDB:post2001:V U	697
SE05754362	Indian Balsam	<i>Impatiens glandulifera</i>	flowering plant	Jun-15	None		Sch9_part2	1,753
SE06434365	Indian Balsam	<i>Impatiens glandulifera</i>	flowering plant	10/06/2011	field observation	LF Count of DAFOR	Sch9_part2	1,606
SE08404215	Indian Balsam	<i>Impatiens glandulifera</i>	flowering plant	06/06/2011	field observation	R Count of DAFOR	Sch9_part2	1,873
SE0551342368	Rhododendron	<i>Rhododendron ponticum</i>	flowering plant	19/06/2010	field record	LF Count of DAFOR	Sch9_part2	1,059
SE05514237	Rhododendron	<i>Rhododendron ponticum</i>	flowering plant	19/06/2015	field record	R Count of DAFOR	Sch9_part2	1,063
SE0573342167	Rhododendron	<i>Rhododendron ponticum</i>	flowering plant	19/06/2010	field record	LF Count of DAFOR	Sch9_part2	799
SE0580042210	Rhododendron	<i>Rhododendron ponticum</i>	flowering plant	19/06/2010	field record	R Count of DAFOR	Sch9_part2	741
SE05814366	Rhododendron	<i>Rhododendron ponticum</i>	flowering plant	04/07/2012	field observation	O Count of DAFOR	Sch9_part2	1,764
SE0582942326	Rhododendron	<i>Rhododendron ponticum</i>	flowering plant	19/06/2015	field record	R Count of DAFOR	Sch9_part2	748
SE0584042390	Rhododendron	<i>Rhododendron ponticum</i>	flowering plant	19/06/2010	field record	O-LF Count of DAFOR	Sch9_part2	765

Grid Ref	Common Name	Latin Name	Taxon Group	Date	Record Type	Abundance	Designation	Distance from site centroid (m)
SE058438	Rhododendron	<i>Rhododendron ponticum</i>	flowering plant	31/01/1978	field record		Sch9_part2	1,896
SE0598041910	Rhododendron	<i>Rhododendron ponticum</i>	flowering plant	19/06/2015	field record	R Count of DAFOR	Sch9_part2	560
SE0742	Rhododendron	<i>Rhododendron ponticum</i>	flowering plant	06/07/1983	field record		Sch9_part2	476
SE08404215	Rhododendron	<i>Rhododendron ponticum</i>	flowering plant	06/06/2011	field observation	O Count of DAFOR	Sch9_part2	1,873
SE08524215	Rhododendron	<i>Rhododendron ponticum</i>	flowering plant	11/04/2012	field observation	R Count of DAFOR	Sch9_part2	1,992
SE07194241	Japanese Rose	<i>Rosa rugosa</i>	flowering plant	11/09/2012	field observation	LF Count of DAFOR	Sch9_part2	756
SE061426	Water-Soldier	<i>Stratiotes aloides</i>	flowering plant	21/06/1996	field record	F Range of DAFOR	RDB:post2001: NT	697
SE061426	Water-Soldier	<i>Stratiotes aloides</i>	flowering plant	16/09/2002	field record	LA Range of DAFOR	RDB:post2001: NT	697
SE061426	Water-Soldier	<i>Stratiotes aloides</i>	flowering plant	11/09/1986	field record	Dominant Count of DAFOR	RDB:post2001: NT	697
SE061426	Water-Soldier	<i>Stratiotes aloides</i>	flowering plant	1977	field record		RDB:post2001: NT	697
SE051409	Pterostichus cristatus	<i>Pterostichus cristatus</i>	insect - beetle (Coleoptera)	13/07/2010	Sweep netted		Notable:B	1,825
SE0517240905	Pterostichus cristatus	<i>Pterostichus cristatus</i>	insect - beetle (Coleoptera)	13/07/2010	field record		Notable:B	1,767
SE0508840885	Amblytylus brevicollis	<i>Amblytylus brevicollis</i>	insect - true bug (Hemiptera)	13/07/2010	Sweep netted		Notable:B	1,844

Grid Ref	Common Name	Latin Name	Taxon Group	Date	Record Type	Abundance	Designation	Distance from site centroid (m)
SE0509040915	Amblytylus brevicollis	<i>Amblytylus brevicollis</i>	insect - true bug (Hemiptera)	13/07/2010	Sweep netted		Notable:B	1,824
SE051409	Amblytylus brevicollis	<i>Amblytylus brevicollis</i>	insect - true bug (Hemiptera)	13/07/2010	Sweep netted		Notable:B	1,825
SE064432	Grass Snake	<i>Natrix natrix</i>	reptile	1890	field record		Sch5_sect9.1 (part) & 9.5; UKBAP; WYBAP	1,160
SE058438	Hedgehog	<i>Erinaceus europaeus</i>	terrestrial mammal	Unknown	field record		UKBAP; WYBAP	1,896
SE066414	West European Hedgehog	<i>Erinaceus europaeus</i>	terrestrial mammal	04/07/2014	dead on road	1 Count	UKBAP; WYBAP	650
SE048427	Brown Hare	<i>Lepus europaeus</i>	terrestrial mammal	06/03/1981	field record	1 Count of Adult	UKBAP; WYBAP; Bradford BAP	1,840
SE05004303	Brown Hare	<i>Lepus europaeus</i>	terrestrial mammal	07/05/1986	field record	1 Count of Adult	UKBAP; WYBAP; Bradford BAP	1,811
SE058438	Brown Hare	<i>Lepus europaeus</i>	terrestrial mammal	Unknown	field record		UKBAP; WYBAP; Bradford BAP	1,896
SE056433	Otter	<i>Lutra lutra</i>	terrestrial mammal	20/02/2009	tracks/trail		Sch5; UKBAP; WYBAP; Bradford BAP	1,556
SE051409	Unidentified Bat	<i>Myotis</i>	terrestrial mammal	23/07/2010	field record	1 Count	Sch5	1,825
SE051409	Unidentified Bat	<i>Myotis</i>	terrestrial mammal	11/08/2010	field record	1 Count	Sch5	1,825
SE051409	Unidentified Bat	<i>Myotis</i>	terrestrial mammal	29/06/2010	field record	1 Count	Sch5	1,825

Grid Ref	Common Name	Latin Name	Taxon Group	Date	Record Type	Abundance	Designation	Distance from site centroid (m)
SE051409	Unidentified Bat	<i>Myotis</i>	terrestrial mammal	30/06/2010	field record	1 Count	Sch5	1,825
SE051409	Unidentified Bat	<i>Myotis</i>	terrestrial mammal	22/07/2010	field record	1 Count	Sch5	1,825
SE0602241270	Daubenton's Bat	<i>Myotis daubentonii</i>	terrestrial mammal	09/05/2007	in building	1 Count of Adult	Sch5; WYBAP	924
SE07434041	Whiskered Bat	<i>Myotis mystacinus</i>	terrestrial mammal	19/08/2005	Grounded	1 Count of Adult	Sch5; WYBAP	1,868
SE0683640618	Leisler's Bat	<i>Nyctalus leisleri</i>	terrestrial mammal	12/09/2015	field record		Sch5; WYBAP	1,461
SE051409	Noctule	<i>Nyctalus noctula</i>	terrestrial mammal	22/07/2010	field record	1 Count	Sch5; UKBAP; WYBAP	1,825
SE051409	Noctule	<i>Nyctalus noctula</i>	terrestrial mammal	23/07/2010	field record	1 Count	Sch5; UKBAP; WYBAP	1,825
SE051409	Noctule	<i>Nyctalus noctula</i>	terrestrial mammal	12/08/2010	field record	1 Count	Sch5; UKBAP; WYBAP	1,825
SE05884210	Pipistrellus	<i>Pipistrellus</i>	terrestrial mammal	29/04/2005	Grounded	1 Count of Adult	Sch5	645
SE0627141061	Pipistrellus	<i>Pipistrellus</i>	terrestrial mammal	01/09/2005	Roost		Sch5	1,017
SE06634031	Pipistrellus	<i>Pipistrellus</i>	terrestrial mammal	27/06/2005	in building	1 Count of Juvenile	Sch5	1,738
SE051409	Pipistrelle	<i>Pipistrellus pipistrellus</i>	terrestrial mammal	23/07/2010	field record	3 Count	Sch5; WYBAP; Bradford BAP	1,825
SE051409	Pipistrelle	<i>Pipistrellus pipistrellus</i>	terrestrial mammal	11/08/2010	field record	1 Count	Sch5; WYBAP; Bradford BAP	1,825
SE051409	Pipistrelle	<i>Pipistrellus pipistrellus</i>	terrestrial mammal	12/08/2010	field record	4 Count	Sch5; WYBAP; Bradford BAP	1,825
SE051409	Pipistrelle	<i>Pipistrellus pipistrellus</i>	terrestrial mammal	29/06/2010	field record	3 Count	Sch5; WYBAP; Bradford BAP	1,825
SE051409	Pipistrelle	<i>Pipistrellus pipistrellus</i>	terrestrial mammal	30/06/2010	field record	3 Count	Sch5; WYBAP; Bradford BAP	1,825

Grid Ref	Common Name	Latin Name	Taxon Group	Date	Record Type	Abundance	Designation	Distance from site centroid (m)
SE051409	Pipistrelle	<i>Pipistrellus pipistrellus</i>	terrestrial mammal	22/07/2010	field record	3 Count	Sch5; WYBAP; Bradford BAP	1,825
SE0516840852	Pipistrelle	<i>Pipistrellus pipistrellus</i>	terrestrial mammal	30/06/2010	Roost (summer)	1 Count	Sch5; WYBAP; Bradford BAP	1,804
SE0517240934	Pipistrelle	<i>Pipistrellus pipistrellus</i>	terrestrial mammal	11/08/2010	Roost (summer)	1 Count	Sch5; WYBAP; Bradford BAP	1,748
SE05174092	Pipistrelle	<i>Pipistrellus pipistrellus</i>	terrestrial mammal	22/07/2010	Roost (summer)	1 Count	Sch5; WYBAP; Bradford BAP	1,758
SE058438	Pipistrelle	<i>Pipistrellus pipistrellus</i>	terrestrial mammal	Unknown	field record		Sch5; WYBAP; Bradford BAP	1,896
SE06084141	Pipistrelle	<i>Pipistrellus pipistrellus</i>	terrestrial mammal	12/07/2011	Roost (summer)	2 Count	Sch5; WYBAP; Bradford BAP	775
SE0683640618	Common Pipistrelle	<i>Pipistrellus pipistrellus</i>	terrestrial mammal	12/09/2015	field record		Sch5; WYBAP; Bradford BAP	1,461
SE06974290	Common Pipistrelle	<i>Pipistrellus pipistrellus</i>	terrestrial mammal	06/12/2003	Roost	3 Count of Adult	Sch5; WYBAP; Bradford BAP	962
SE0738242935	Common Pipistrelle	<i>Pipistrellus pipistrellus</i>	terrestrial mammal	19/06/2001	Roost	21-50 Count of Adult	Sch5; WYBAP; Bradford BAP	1,233
SE0750942847	Pipistrelle	<i>Pipistrellus pipistrellus</i>	terrestrial mammal	23/05/2006	field record	2 Count	Sch5; WYBAP; Bradford BAP	1,266
SE0801442350	Common Pipistrelle	<i>Pipistrellus pipistrellus</i>	terrestrial mammal	16/07/2001	Roost	2-5 Count of Adult	Sch5; WYBAP; Bradford BAP	1,516
SE051409	Soprano Pipistrelle	<i>Pipistrellus pygmaeus</i>	terrestrial mammal	23/07/2010	field record	1 Count	Sch5; UKBAP; WYBAP; Bradford BAP	1,825
SE051409	Soprano Pipistrelle	<i>Pipistrellus pygmaeus</i>	terrestrial mammal	11/08/2010	field record	3 Count	Sch5; UKBAP; WYBAP; Bradford BAP	1,825
SE051409	Soprano Pipistrelle	<i>Pipistrellus pygmaeus</i>	terrestrial mammal	12/08/2010	field record	1 Count	Sch5; UKBAP; WYBAP; Bradford BAP	1,825

Grid Ref	Common Name	Latin Name	Taxon Group	Date	Record Type	Abundance	Designation	Distance from site centroid (m)
SE051409	Soprano Pipistrelle	<i>Pipistrellus pygmaeus</i>	terrestrial mammal	29/06/2010	field record	3 Count	Sch5; UKBAP; WYBAP; Bradford BAP	1,825
SE051409	Soprano Pipistrelle	<i>Pipistrellus pygmaeus</i>	terrestrial mammal	30/06/2010	field record	1 Count	Sch5; UKBAP; WYBAP; Bradford BAP	1,825
SE0485042660	Pipistrelle Bat species	<i>Pipistrellus sp.</i>	terrestrial mammal	15/07/2002	Roost	40 Count of Adult	Sch5	1,779
SE0485442666	Pipistrelle Bat species	<i>Pipistrellus sp.</i>	terrestrial mammal	21/07/2007	Roost (maternity)	27 Count of Juvenile	Sch5	1,778
SE0485542664	Pipistrelle Bat species	<i>Pipistrellus sp.</i>	terrestrial mammal	2007	Roost	35 Count of Juvenile	Sch5	1,776
SE0486042670	Pipistrelle Bat species	<i>Pipistrellus sp.</i>	terrestrial mammal	15/07/2002	Roost		Sch5	1,774
SE0610041100	Pipistrelle Bat species	<i>Pipistrellus sp.</i>	terrestrial mammal	21/07/2007	Casualty	1 Count of Adult	Sch5	1,036
SE06144124	Pipistrelle Bat species	<i>Pipistrellus sp.</i>	terrestrial mammal	17/09/2004	Injured	1 Count of Adult	Sch5	892
SE0619541689	Pipistrelle Bat species	<i>Pipistrellus sp.</i>	terrestrial mammal	15/12/2006	Roost (possible)	2 Count of Adult	Sch5	485
SE0789642071	Pipistrelle Bat species	<i>Pipistrellus sp.</i>	terrestrial mammal	31/08/2002	Roost		Sch5	1,367
SE0793742466	Pipistrelle Bat species	<i>Pipistrellus sp.</i>	terrestrial mammal	09/07/2007	Roost (maternity)	not recorded Range	Sch5	1,469
SE0793742466	Pipistrelle Bat species	<i>Pipistrellus sp.</i>	terrestrial mammal	09/07/2007	Roost (maternity)		Sch5	1,469
SE0804242445	Pipistrelle Bat species	<i>Pipistrellus sp.</i>	terrestrial mammal	14/08/2007	Roost		Sch5	1,564
SE057438	Eastern Grey Squirrel	<i>Sciurus carolinensis</i>	terrestrial mammal	04/07/2012	field observation		Sch9_part1	1,937
SE058421	Grey Squirrel	<i>Sciurus carolinensis</i>	terrestrial mammal	19/06/2015	field record	2 Count	Sch9_part1	725

Grid Ref	Common Name	Latin Name	Taxon Group	Date	Record Type	Abundance	Designation	Distance from site centroid (m)
SE058438	Grey Squirrel	<i>Sciurus carolinensis</i>	terrestrial mammal	Unknown	field record		Sch9_part1	1,896
SE084421	Eastern Grey Squirrel	<i>Sciurus carolinensis</i>	terrestrial mammal	06/06/2011	field observation		Sch9_part1	1,871
SE0486042670	Bats	<i>Vespertilionidae</i>	terrestrial mammal	2002	casualty (not road)		Sch5	1,774
SE0486042670	Vesper Bat species	<i>Vespertilionidae</i>	terrestrial mammal	23/06/1998	Roost		Sch5	1,774
SE0502042962	Vesper Bat species	<i>Vespertilionidae</i>	terrestrial mammal	19/07/2001	Roost		Sch5	1,758
SE051418	Bats	<i>Vespertilionidae</i>	terrestrial mammal	1997	field record		Sch5	1,442
SE0514940907	Bats	<i>Vespertilionidae</i>	terrestrial mammal	29/06/2010	Roost (summer)	1 Count	Sch5	1,783
SE05164090	Bats	<i>Vespertilionidae</i>	terrestrial mammal	22/07/2010	Roost (summer)	1 Count	Sch5	1,779
SE05694079	Vesper Bat species	<i>Vespertilionidae</i>	terrestrial mammal	06/06/2005	Grounded	1 Count of Adult	Sch5	1,506
SE06024145	Vesper Bat species	<i>Vespertilionidae</i>	terrestrial mammal	25/04/2005	in building	1 Count of Adult	Sch5	780
SE0627141061	Vesper Bat species	<i>Vespertilionidae</i>	terrestrial mammal	16/06/2005	in building	1 Count of Adult	Sch5	1,017
SE06354083	Vesper Bat species	<i>Vespertilionidae</i>	terrestrial mammal	29/07/2005	field record	1 Count of Adult	Sch5	1,228
SE0651043158	Bats	<i>Vespertilionidae</i>	terrestrial mammal	2002	Roost (maternity)		Sch5	1,112
SE06654219	Vesper Bat species	<i>Vespertilionidae</i>	terrestrial mammal	13/06/2005	Roost		Sch5	190
SE07364238	Vesper Bat species	<i>Vespertilionidae</i>	terrestrial mammal	21/08/2004	in building	1 Count of Adult	Sch5	897
SE0746942455	Vesper Bat species	<i>Vespertilionidae</i>	terrestrial mammal	26/06/2005	Roost (maternity)	1 Count of Juvenile	Sch5	1,026

Grid Ref	Common Name	Latin Name	Taxon Group	Date	Record Type	Abundance	Designation	Distance from site centroid (m)
SE075424	Bats	<i>Vespertilionidae</i>	terrestrial mammal	2001	Roost (possible)		Sch5	1,035
SE0756441280	Vesper Bat species	<i>Vespertilionidae</i>	terrestrial mammal	14/07/2003	Roost		Sch5	1,288
SE07684066	Vesper Bat species	<i>Vespertilionidae</i>	terrestrial mammal	06/08/2004	Grounded	1 Count of Adult	Sch5	1,802
SE07734255	Vesper Bat species	<i>Vespertilionidae</i>	terrestrial mammal	05/11/2003	in building		Sch5	1,303
SE0804142442	Bats	<i>Vespertilionidae</i>	terrestrial mammal	2007	Roost		Sch5	1,563
SE0805842128	Vesper Bat species	<i>Vespertilionidae</i>	terrestrial mammal	25/06/2005	Roost	1 Count of Juvenile	Sch5	1,531
SE08164232	Vesper Bat species	<i>Vespertilionidae</i>	terrestrial mammal	08/08/2005	Grounded	1 Count of Adult	Sch5	1,653